



US010456843B2

(12) **United States Patent**  
**Gerst**

(10) **Patent No.:** **US 10,456,843 B2**  
(45) **Date of Patent:** **Oct. 29, 2019**

(54) **VIBRATING CUTTER TOOL CIRCULAR CUTTING JIG**

USPC ..... 33/27.031  
See application file for complete search history.

(71) Applicant: **Gerald A Gerst**, Bantam, CT (US)

(56) **References Cited**

(72) Inventor: **Gerald A Gerst**, Bantam, CT (US)

U.S. PATENT DOCUMENTS

(\*) Notice: Subject to any disclaimer, the term of this patent is extended or adjusted under 35 U.S.C. 154(b) by 215 days.

5,044,238 A \* 9/1991 Etcheparre ..... B26D 9/00  
451/423

(21) Appl. No.: **15/692,305**

5,271,301 A \* 12/1993 Hiraoka ..... B23B 29/125  
407/6

(22) Filed: **Aug. 31, 2017**

2002/0152851 A1\* 10/2002 Moriwaki ..... B23B 25/02  
82/1.11

(65) **Prior Publication Data**

US 2018/0065189 A1 Mar. 8, 2018

2007/0180961 A1\* 8/2007 Imai ..... B23B 29/125  
82/1.5

**Related U.S. Application Data**

(60) Provisional application No. 62/382,830, filed on Sep. 2, 2016.

2007/0233131 A1\* 10/2007 Song ..... A61B 17/1671  
606/79

(51) **Int. Cl.**

**B23B 47/28** (2006.01)  
**B23D 45/02** (2006.01)  
**B23B 51/05** (2006.01)  
**B26F 1/38** (2006.01)  
**B03B 5/24** (2006.01)  
**B23Q 9/00** (2006.01)  
**B27B 19/00** (2006.01)

2012/0181730 A1\* 7/2012 Edwards ..... B23B 47/34  
264/442

\* cited by examiner

*Primary Examiner* — Yaritza Guadalupe-McCall

(74) *Attorney, Agent, or Firm* — Gregory Stauf

(52) **U.S. Cl.**

CPC ..... **B23B 47/281** (2013.01); **B23B 51/05**  
(2013.01); **B23D 45/025** (2013.01); **B26F**  
**1/3846** (2013.01); **B03B 5/24** (2013.01); **B23Q**  
**9/0078** (2013.01); **B27B 19/006** (2013.01)

(57) **ABSTRACT**

A circular jig apparatus to allow cutting or marking of large circular holes in sheets of material using a tool with a cutting blade or marking device is disclosed. This apparatus includes a system to hold the hold the tool in place, adjust the size or radius of the circular hole, and guide the cutting blade or marking device around in a circle on the sheet of material. In particular the cutting tool may be a vibrating blade. A system is also disclosed to match the curvature of the cutting blade to the arc or radius of the circle being cut. A system is also disclosed to provide a depth stop for the cutting blade. A system to hold a wide variety of marking or dispensing devices for use with the circular jig is also disclosed.

(58) **Field of Classification Search**

CPC ..... B03B 5/24; B26F 1/3846; B27B 19/006;  
B23B 47/281; B23B 51/05; B23D  
45/025; B23Q 9/0078

**24 Claims, 6 Drawing Sheets**

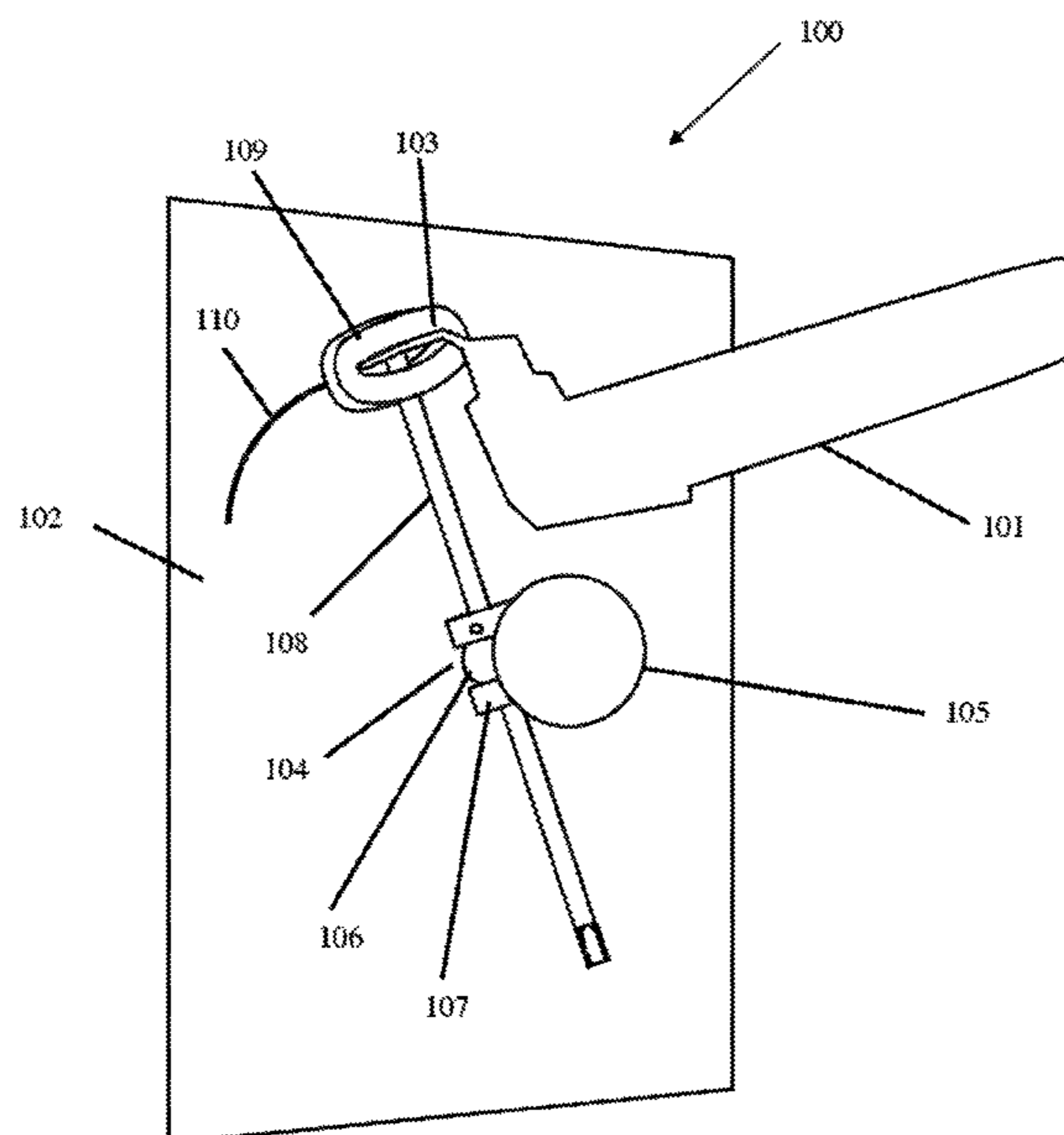

FIG. 1

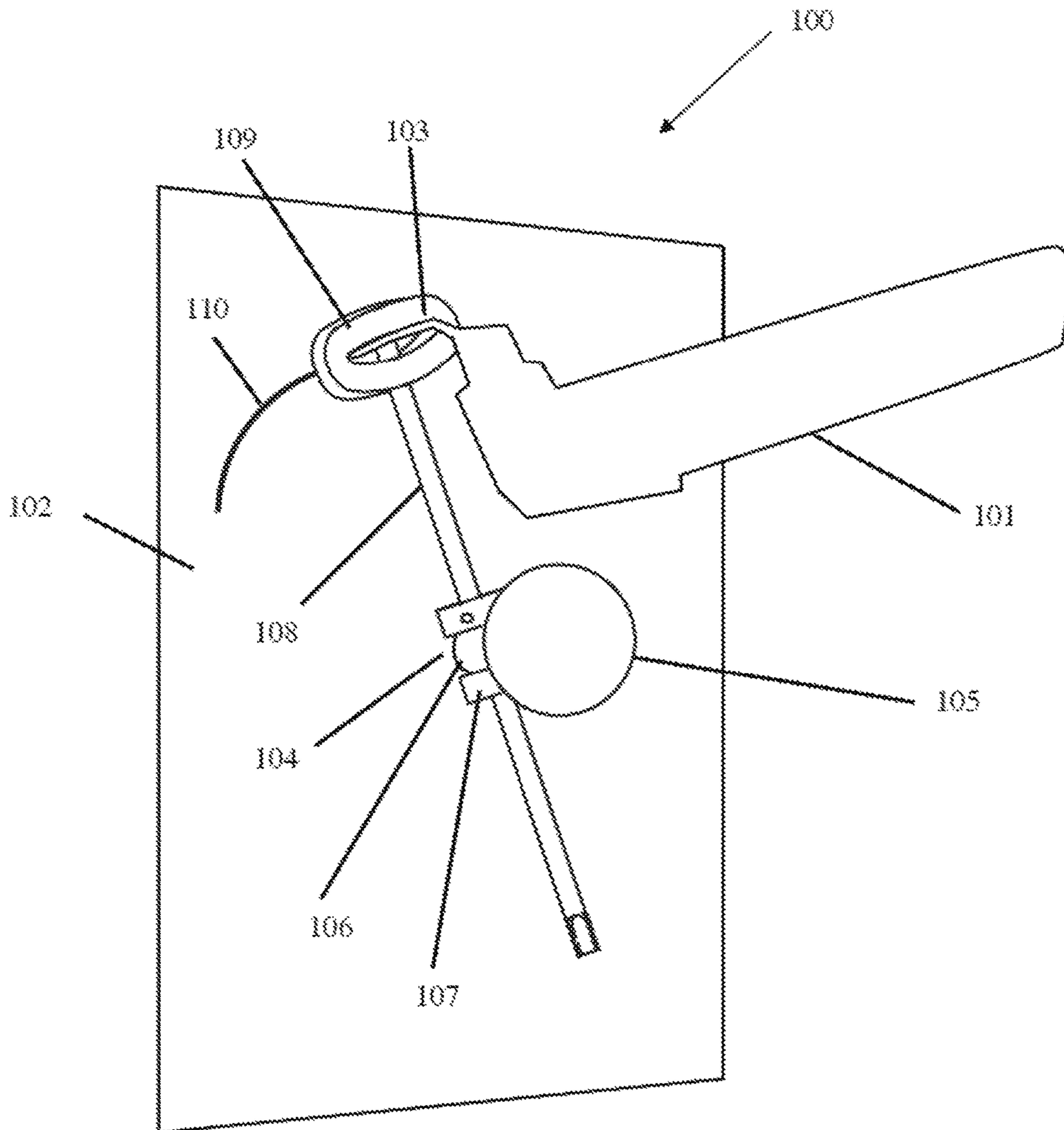

FIG. 2

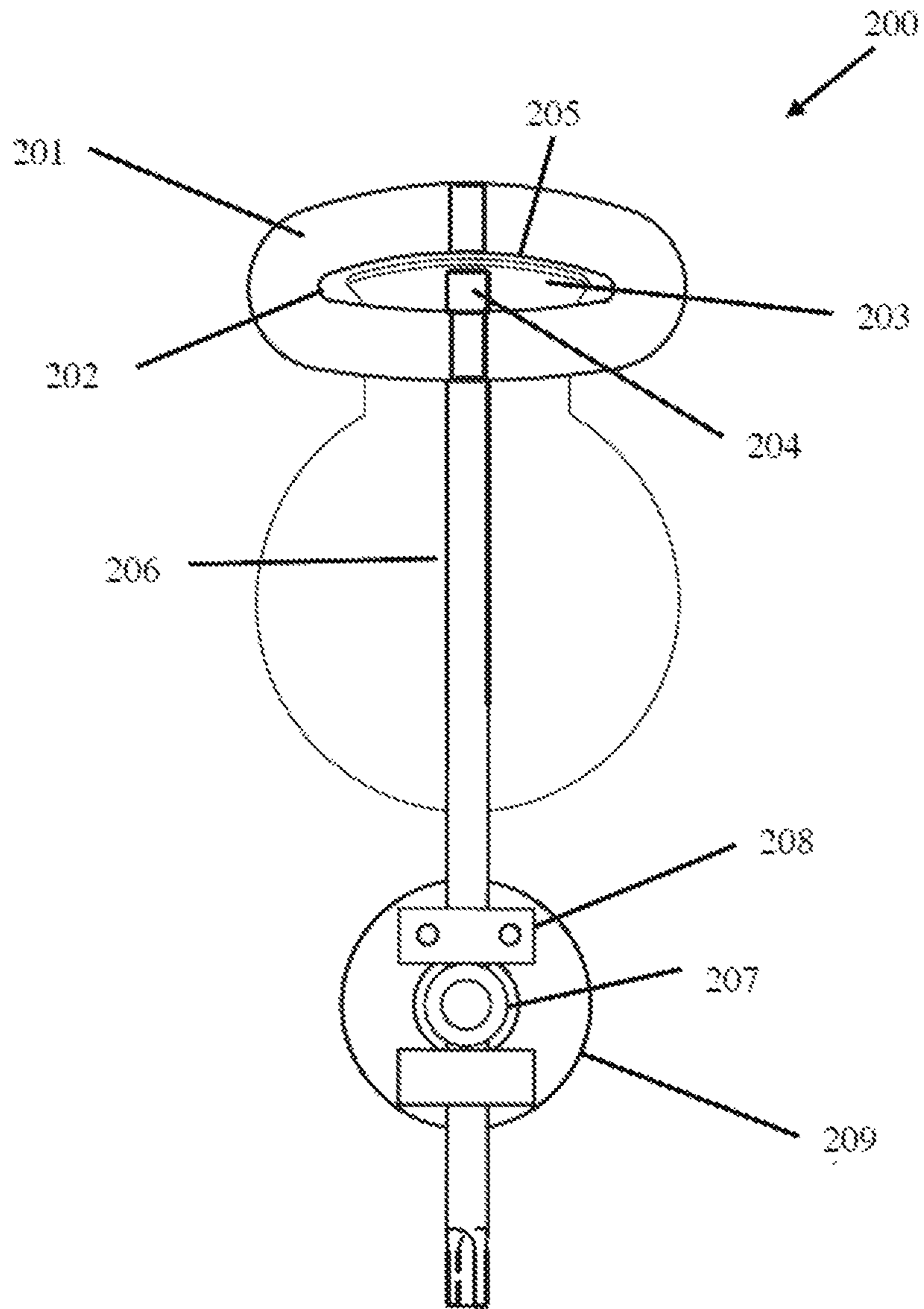

FIG. 3

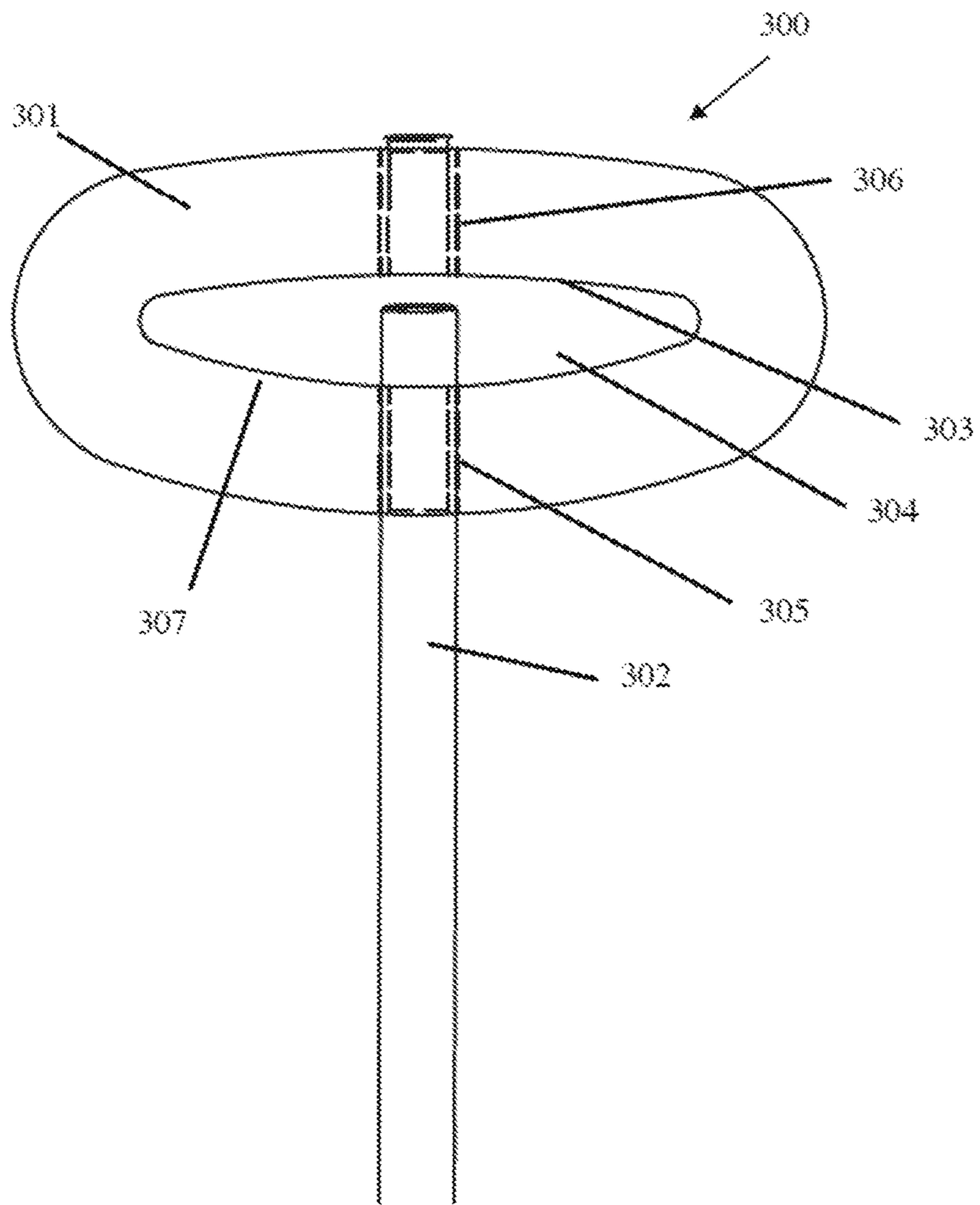

FIG. 4

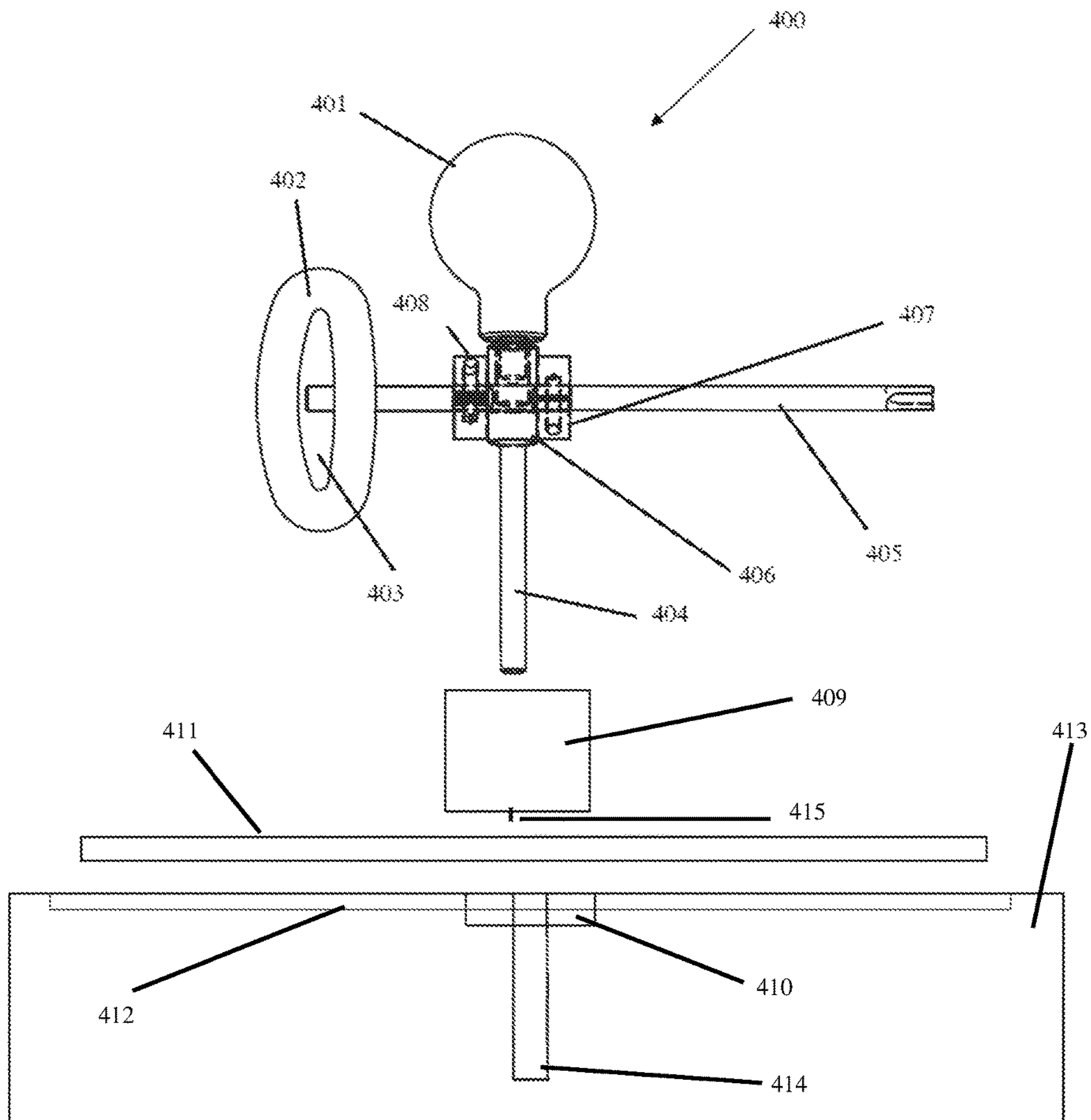



FIG. 5

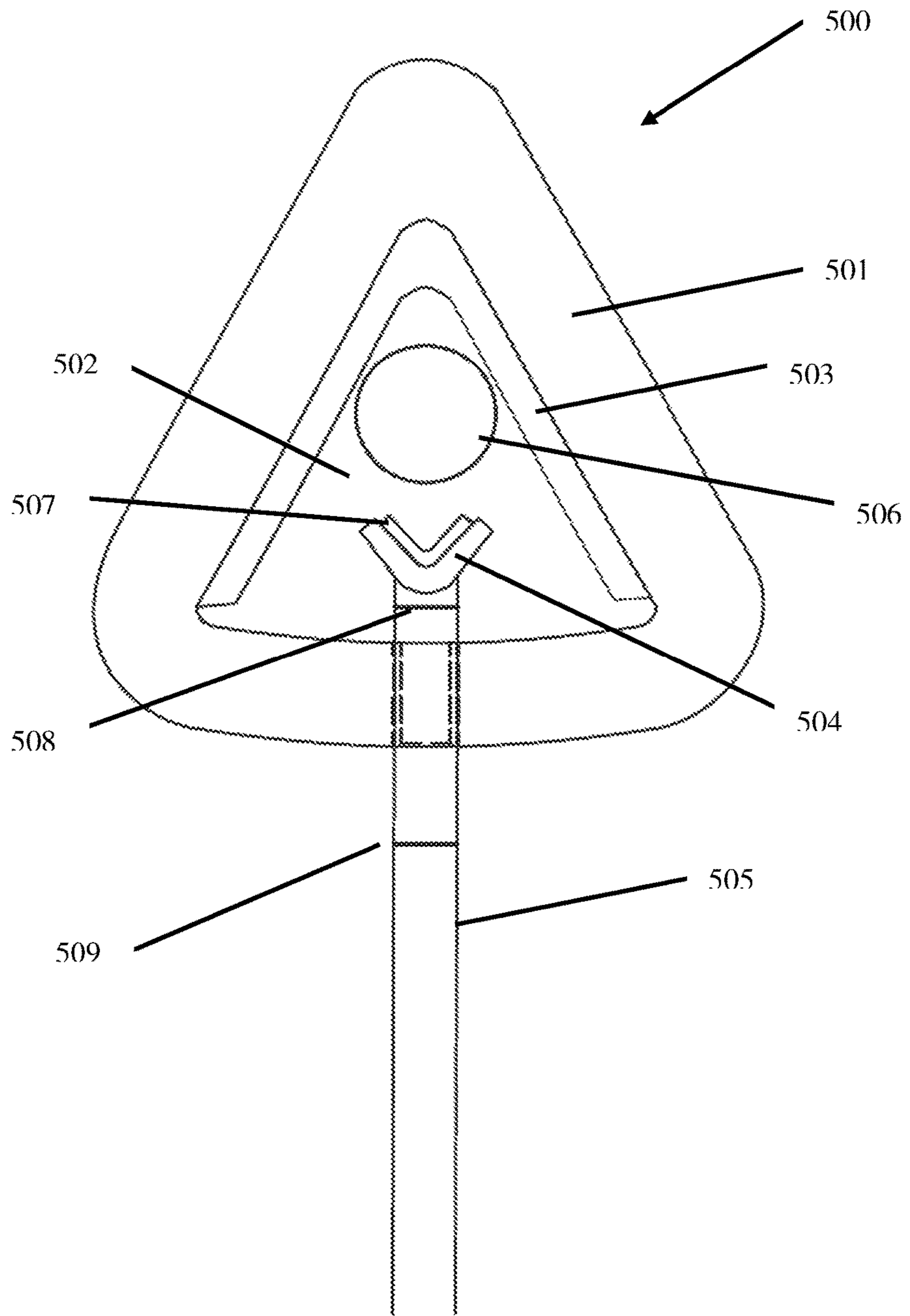
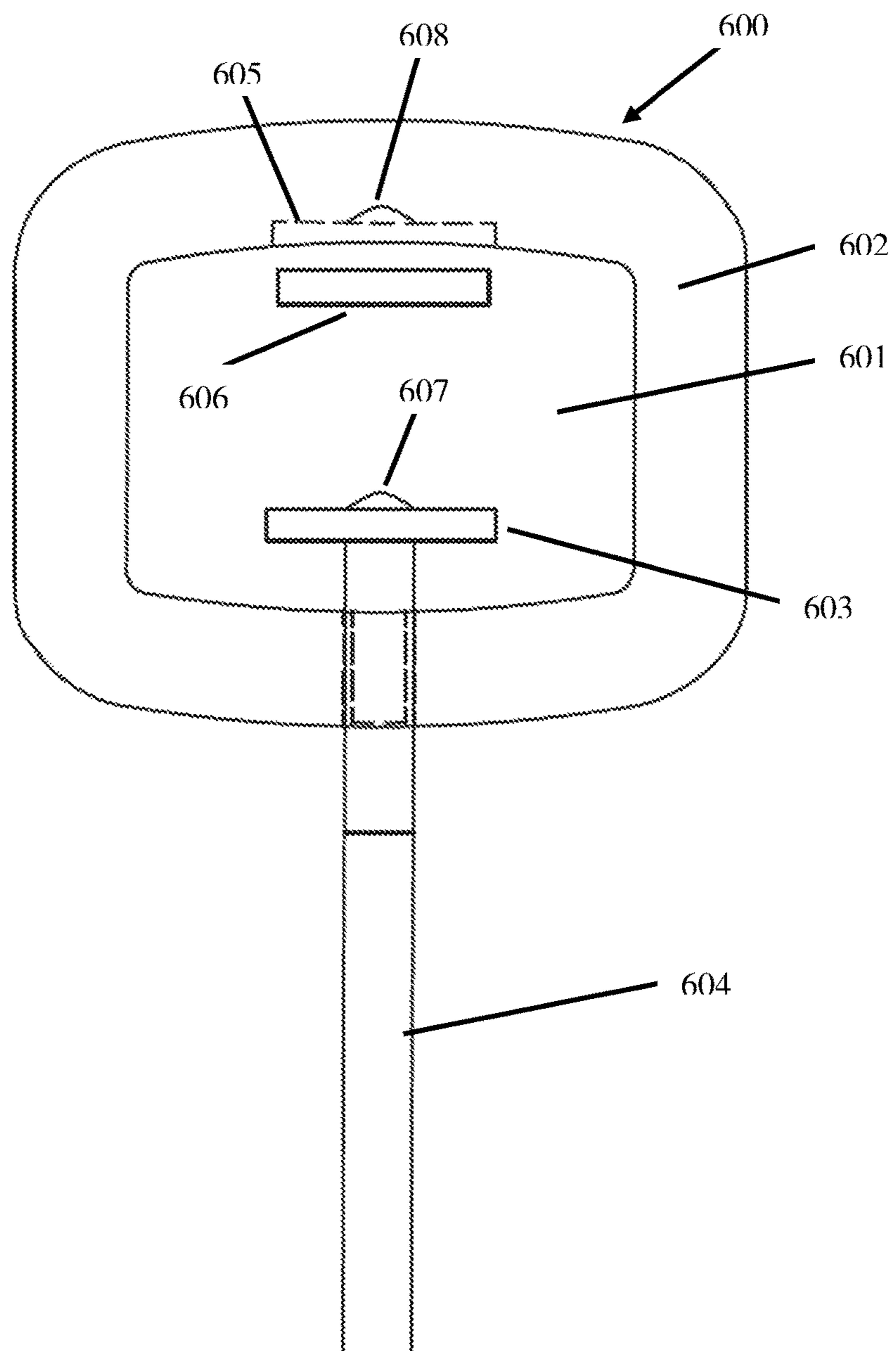

FIG. 6





1

## VIBRATING CUTTER TOOL CIRCULAR CUTTING JIG

### CROSS REFERENCE TO RELATED APPLICATIONS

U.S. Provisional Application 62/382,830, filed Sep. 2,  
2016

### BACKGROUND OF THE INVENTION

#### REFERENCES

N/A

The invention described herein relates generally to an apparatus which provides a convenient way to cut circular holes of different diameters in a wide variety of materials.

### SUMMARY DISCLOSURE OF INVENTION

The invention described herein relates generally to an apparatus which provides a jig or guide for circular hole cutting with a vibrating cutting tool, allowing it to quickly and easily cut circular holes in a variety of materials. The circular holes can be of a wide range of diameters, with a relatively small set of jigs or guides, based on adjustments of the jigs or guides, allowing it to be used for a variety of holes, such as for speakers, ducts, and lighting fixtures. Because of use of the vibrating blade, or “vibro” cutting tool, there is minimal damage to finished surfaces, allowing it to be used where there are only small covering sections or trim plates to hide hole edges. The guide also allows for convenient one-handed operation when a surface is fixed in place, and generates minimal dust compared to most types of saws. Finally, it allows large, uniform holes to be cut in sheets of materials where there is inadequate space to use a conventional hole saw or jig saw.

One embodiment of this invention lets it cut circular holes ranging from 2" to 14" in diameter, by making several adjustments on the guide. Other embodiments include systems for holding a variety of cutting, piercing and marking implements to cut, pierce or mark sheets of material.

### BRIEF DESCRIPTION OF DRAWINGS

FIG. 1 shows a diagram of the circular hole cutting guide in use with a cutting blade on a sheet of material.

FIG. 2 shows a close up diagram of the underside of the circular hole cutting guide.

FIG. 3 shows a diagram of the vibrating blade holding part of the circular hole cutting guide.

FIG. 4 shows a diagram of the circular hole cutting guide from the side.

FIG. 5 shows a diagram of a generally round marking or patterning item holding embodiment of the circular hole cutting guide.

FIG. 6 shows a diagram of a generally flat marking or patterning item holding embodiment of the circular hole cutting guide.

### MODE(S) FOR CARRYING OUT THE INVENTION—DETAILED DESCRIPTION

The present invention and its various embodiments are described below, with reference to figures as necessary. Reference numbers are used to match particular elements described in the text with those shown in figures. Although

2

the embodiments disclosed will be described with reference to the embodiments shown in the drawings, it should be understood that the embodiments disclosed can be embodied in many alternate forms of embodiments. In addition, any suitable size, shape or type of elements or materials could be used.

In particular, while this invention may be discussed in relation to its use with a vibrating blade cutting tool, it could clearly be used with a variety of cutting tools which may have flexible or thin cutting blades, such as, but not limited to, certain types of reciprocating saws.

FIG. 1 shows a diagram of the vibrating blade cutting tool guide **100** in use. Vibrating tool **101**, such as, but not limited to, a Fein Multimaster, is normally used to cut relatively soft flat, sheet-like materials such as wood, plastic, fiberboard, and so on **102** using vibrating blade **103**. In some cases it may be desirable to cut a specific sized hole in the flat sheets for things such as ducts, sink basins, speakers, lighting fixtures, and so on. In this embodiment of the invention, a center hole **104** is made (under the spherical gripper **105** shown), and a pivot post **106** (also under the spherical gripper **105**) placed into the hole **104**. Note that other methods of attaching the pivot post **106** could be used, such as, but not limited to, clamping from above or below, magnets, a suction cup, or screwing the pivot post down. This may be particularly helpful if the circular hole cutting guide is being used to cut a hole in a material where the cut out disk is the desired final product, so should not be damaged. A suction cup would work particularly well for attaching the pivot post **106** to flat materials like plexiglass or glass. Also note that it is not required that this center hole **104** be drilled all the way through the sheet, a blind hole with a small screw could be used, making it easier to plug or fill the hole later. Also note that while the gripper **105** is described as spherical, it could have a variety of shapes for convenient gripping, such as, but not limited to, a knurled knob, an oval, or a bar, or could be minimized in size to make a smaller tool. The pivot post **106** could comprise a variety of materials and devices, such as a threaded metal bolt, a drill bit, a plastic or wooden peg, a magnetic device, and so on, it merely acts as a center pivot for slider bracket **107** which is used to allow length adjustment of a sliding arm, slider **108**, so that blade holder **109** can be placed at different radii from the original hole **104**, thus allowing holes of different radii to be cut in sheet **102**. This adjustable sliding arm or slider **108** can be made of a variety of materials, including but not limited to plastic, metal, wood, wire, chain, metal tape or string, and in particular may be rigid or flexible. In a particular embodiment of this invention, guide marks on the slider **108** can be used to set different hole radiuses as slider **108** is slid back and forth in slider bracket **107**. A variety of systems can be used to hold slider **108** in place in slider bracket **107** such as, but not limited to, clamps, set screws, and springs. These can be combined with foam, rubber, silicone or other “grippy” materials to help hold the slider in place. A spring retraction system such as tape measures use may also be employed to pull the slider **108** back to the either the slider bracket **107** or blade holder **109**, particularly if the slider is flexible such as wire, chain, metal tape or string. The beginning arc **110** of a hole being cut in sheet **102** can be seen in FIG. 1.

Note that in this case while the body **101** of the vibrating blade cutting tool is shown extending out parallel to the blade **103**, perpendicular to sheet **102**, in some models of these tools the body **101** can be rotated 90 degrees relative to the blade **103** where the blade attaches to the body of the tool such that the body **101** of the tool would be roughly



parallel to the sheet of material **102**. This would allow hole **110** to be cut in the sheet of material **102** with very limited accessible clearance above the sheet of material **102**, as little as a few inches, showing one of the advantages of this invention relative to things like conventional hole saws or jig saws, which would require much more clearance above the sheet of material **102**. It is also apparent that in such an application, where the sheet of material was fixed in place, the invention could be used to cut a hole with just one hand needed to guide it, though another hand could also be used on gripper **105** if needed.

FIG. 2 shows a diagram of a close up of the underside of the vibrating blade cutting tool guide **200**. Blade holder **201** has an elongated slot **202** cut in it and passing through the body of the blade holder, of a suitable size to hold vibrating cutting blade, **203**. The long direction of this slot is approximately perpendicular to the direction in which the slider can be adjusted, and is parallel to the direction of the flat of the vibrating blade. Note the slight curvature in blade **203**, this is because there is a rod **204** pressing thin, flexible blade **203** against the curved interior side **205** of the elongated slot **202** of blade holder **201**, thereby causing the blade **203** to take on a shallow arc approximately matching the arc needed for a large hole **110** being cut in a sheet of material **102**. Matching the curve of the slot **202** with the arc of the large hole provides a smaller cut line and cleaner edge than would be the case if a flat blade **203** were merely being maneuvered in a circle, for example by following a traced line on the surface of the sheet of material without the apparatus of this invention. In this embodiment rod **204** is the same as the slider **206** or **108** (FIG. 1) but in an alternative embodiment rod **204** could be a separate set screw set into blade holder **201**. Other ways and locations of having access to the set screw or rod **204** are intended to be covered by this disclosure. Other systems of holding the blade **203** into the blade holder **201**, such as, but not limited to, clamps, springs and pegs are also intended to be covered by this disclosure. Blade holder **201** is fastened to slider **206**, which is used to adjust the radius at which blade **203** is positioned from center hole **104** (FIG. 1) and thereby the radius of the hole **110** which is cut in the sheet of material **102** (FIG. 1). Pivot post **207**, slider bracket **208** and spherical gripper **209** are also shown in this diagram.

In another embodiment of this invention, if the cutting blade **203** is not wide and flexible enough to be bent, but rather narrow and stiff, the rod **204** could still hold the blade **203** into a slot and the blade holder **201** could still be used to guide the cutting blade in a large circle to cut out a circular hole in a sheet of material. Because the blade is narrow in such an embodiment, it is not as critical to bend the blade in an arc as described in the previous embodiment.

In another embodiment of this invention, the blade holder **201** could be used as a stand-alone device attached to the cutting blade **203**, attaching the blade **203** with a specific amount protruding through the slot **202** so that the blade holder **201** can be used as a depth stop for the cutting blade **203**. In this way the blade can cut any shape in a sheet of material without penetrating beyond a desired distance in the sheet of material. This would allow a groove to be cut in the sheet of material without cutting all the way through the sheet of material, if the blade protrusion is set to less than the thickness of the sheet of material. Such grooves could be used for decorative effects, or guide marks, or scribe lines for later "snapping" of the sheet of material. It would also allow cutting all the way through the sheet of material if the blade **203** protrusion is set to more than the thickness of the sheet of material, but prevent the cutting blade **203** from

penetrating too far past the sheet of material on the far side of the sheet of material. This can be desirable if, for example, there are wires or plumbing behind a sheet of wallboard and the user of the tool does not want to accidentally cut into them.

In another embodiment of this invention, it would also be possible to insert a cutting or marking item other than the vibrating blade cutting tool into the slot **202**. Examples could include a pen or pencil for marking a surface in a circle. Other examples could include a utility knife for cutting a circle in a soft material such as wallboard or ceiling tiles. More examples of this are discussed later.

Blade holder **201**, in this embodiment, is made of soft plastic, such as, but not limited to, polyethylene or Teflon. A variety of materials can be used, from soft to hard, like aluminum or stainless steel, since the rod **204** holds the vibrating blade **203** against the blade holder **201**, causing the blade and blade holder to vibrate together and thereby preventing the blade **203** from cutting through the blade holder. In another preferred embodiment the blade holder **201** is made of a metal such as, but not limited to, aluminum, which is hard enough not to wear away during use. In another embodiment the blade holder **201** could be made of a resin composite. It may also be desirable to chamfer or round the lower corners, e.g. the corners facing the sheet of material **102** (FIG. 1) in particular of the blade holder **201** in order to prevent sharp bottom corners of the blade holder **201** from vibrating against and/or scuffing the surface of the sheet of material **102** (FIG. 1). It may also be desirable to form the blade holder **201** in a convex shape, upwardly curved towards its edges, on at least its lower horizontal surface to prevent the edges or corners of the blade holder **201** from vibrating against and/or scuffing the surface of the sheet of material **102** (FIG. 1).

Some types of reciprocating type saw blades could also be used, providing they do not reciprocate up and down so much that they bang the blade holder against the material sheet **102** (FIG. 1) unacceptably, given that the blade is fixed to the blade holder **201** by the rod **204** in this embodiment of the invention. In some embodiments this invention is intended to cover such other types of cutting blades.

FIG. 3 shows another embodiment of the invention **300**, in particular the blade holder **301**. In an embodiment of the invention, a coupling nut would be used between slider **302** (also **209** in FIG. 2 or **107** in FIG. 1) and a rod or screw **302** which serves the purpose of rod **204** in FIG. 2. In an embodiment of the invention, the screw **302** would press a thin blade such as a vibrating blade **203** in FIG. 2 against the curved side **303** of an interior slot **304** of blade holder **301**. The particular side **303** shown here has a radius of curvature corresponding to a 4" hole which would be cut in a sheet of material. Thus, when the slider would be adjusted to a 4" distance from a center hole such as **104** from FIG. 1, and the screw **302** is screwed into threaded hole **305** in blade holder **301** and the vibrating blade was held down by the screw **302**, the vibrating blade would be held at a curvature which would exactly match that needed to trace a 4" radius or 8" diameter hole in the sheet of material.

Conversely, if screw **303** was moved from threaded hole **305** in blade holder **301** to threaded hole **306** on the other side of blade holder **301**, it would press a vibrating blade against the other side **307** of the slot **304** in blade holder **301**. The other side **307** of the slot **304** has a different and sharper radius of curvature, 2" in this embodiment. Thus, by flipping or reversing the blade holder **302** on the end of the adjustable arm **302** (**108** in FIG. 1 or **206** in FIG. 2) a 4" radius hole could be cut in a sheet of material using the same blade



5

holder **301** and vibrating blade. This gives a great deal of flexibility in hole sizes which can be cut in sheets of material by using a few different interchangeable blade holders, particularly since there does not need to be an exact match between the radius of curvature the vibrating blade is bent into and the radius of curvature of the hole being cut in the sheet of material, especially at larger hole sizes. Thus, using the 4" radius side **303** of the blade holder **301** would allow the slider to be adjusted to give a 5" radius hole, and a very smooth, uniform hole could still be cut in the sheet of material.

In an alternative embodiment of this invention, not shown, multiple slots **304** could be placed in the same piece of blade guide **301** (or **201** from FIG. 2) material, each with a single arced side, or a double arced side as shown by **303** and **307** in FIG. 3, depending on how the set screw or rod system was configured. This would allow a variety of hole sizes to be formed in a sheet of material using a single blade guide template.

FIG. 4 shows the circular hole cutting guide **400** in a side view. Shown are gripper **401**, blade holder **402** with slot **403**, pivot post **404**, and slider bar **405**. Slider bar **405** slides in and is adjusted to a particular hole radius using slider bracket **406**. Slider bar **405** can be held in place in slider bracket **406** by a variety of methods, such as bolts **407** and **408** shown. Other methods include spring loaded clamps or a threaded hole through the entire assembly, through which rod **405** is screwed to adjust the distance between pivot post **404** and blade holder **402**.

Also shown in FIG. 4 are several systems for holding the circular hole cutting guide **400** down. In one embodiment, magnets **409** and **410** hold the circular hole cutting guide **400** down, pinning sheet of material **411** to be cut or marked down against a self healing cutting mat **412** which is mounted on backing support or cutting base **413**. In another embodiment, hole **414** can receive peg **404** to hold the circular hole cutting guide in place. In another embodiment, pin **415** holds the circular hole cutting guide **400** in place, with pressure from the hand on gripper **401** used to keep the circular hole cutting guide **400** from moving.

Sheet of material **411** to be cut or marked can, in any embodiment discussed, may include, but are not limited to, paper, plastic, cardboard, sheetrock, foam core board, decal sheets, linoleum, acetate, glass acrylic, polystyrene, Styro-foam, insulation, silicone, fabric, wood and metal.

FIG. 5 shows another embodiment **500** of the "blade holder" which is adapted to hold a variety of other devices besides the vibrating cutting blade discussed earlier. Holder **501** has a central opening **502**, which may have a variety of shapes but is illustrated here as approximately triangular. A gripping surface **503** which may be removable may comprise a variety of "grippy" materials such as adhesive strips, silicone rubber, and so on. A small counter pressing triangular surface **504** may be attached to the rod or screw **505** (which may be the same as, for example, **302** or **204** in previous diagrams), which may be moved forward in opening **502** as in other embodiments in order to hold cutting, piercing or marking device **506** against the interior surface of gripping surface **503** or opening **502**. Counter pressing surface **504** may, like holder **501**, have a gripping surface which may be removable comprising a variety of "grippy" materials such as adhesive strips, Velcro, silicone rubber, rubber, "sharkskin", and so on, or may be roughened to improve grip. Locations **508** and **509** show where attachments may be made to the rod or screw **505**, either or both of these locations may include pivots to allow more versatile movement of the assembly **500**.

6

Examples of cutting, piercing or marking device **506** include, but are not limited to, pens, pencils, charcoal, chalk, markers, an Exacto or other blade in a handle which may rotate, super glue or other glue dispensers, a hot glue gun, a dispenser with nozzle tip holding glaze, paint, dye, glue or ink, a heated device such as a wood burner, soldering iron, or heated blade tip for cutting or scoring foam core board, a pointed tip for piercing, or a glass cutting or scribing blade. Embodiment **500** of this invention is particularly suited to holding generally cylindrical shapes for cutting, piercing or marking. Any embodiment of this invention may hold such a variety of cutting, piercing or marking devices. If a liquid such as glue is being dispensed, it may act as a fastening location for application of decorative items such as glitter or fabric. The cutting, piercing or marking device **506** is generally mounted in any embodiment such that its cutting, piercing or marking tip protrudes through the opening and is approximately perpendicular to the cross section of the opening **502** so that it can cut, pierce or mark a sheet of material such as **411** in FIG. 4 or **102** in FIG. 1.

FIG. 6 shows another embodiment **600** of the "blade holder" which is adapted to hold a variety of other devices besides the vibrating cutting blade discussed earlier. In this case the embodiment is adapted to hold cutting, piercing or marking devices which are generally flat on at least two sides. Opening **601** in holder **602** is generally rectangular, while movable surface **603** mounted to screw or rod **604** is approximately flat. In a preferred embodiment, a recess **605** sized and shaped for an Exacto style blade **606** is made in holder **602** opposite the movable surface **603**, and both are shaped with corresponding pin **607** and socket **608** to fit into the hole or slot on a standard Exacto blade **606** and thereby hold the blade **606** in place in the assembly **600**. As in the previous embodiment, grippy materials (not shown) may be mounted removably to the movable surface **603** and recess **605** or the opposing side of **602**. Also as in the previous embodiment movable surface **604** may be detachable from or pivot on screw or rod **605**.

It should be understood that the foregoing description is only illustrative of the embodiments. It should also be understood that the embodiments disclosed herein may be used individually or in any suitable combination thereof. Various alternatives and modifications can be devised by those skilled in the art without departing from the embodiments, in particular using a range of tools having a variety of cutting blade types in the apparatus. Accordingly, the present embodiments are intended to embrace all such alternatives, modifications and variances.

What is claimed is:

1. An apparatus for cutting an approximately circular large hole in a sheet of material, comprising; a cutting tool which employs a flat cutting blade, a pivot post which is attached in the center of a portion of the sheet of material which is going to be cut out, an adjustable sliding arm connected at one end to the pivot post, the adjustable sliding arm being connected at the other end to a blade holder, the blade holder having an elongated slot passing through the body of the blade holder, the long direction of the slot being approximately perpendicular to the direction in which the adjustable sliding arm can be adjusted, the blade holder having provision to fasten the cutting blade into the slot such that the flat of the cutting blade is approximately parallel to the long direction of the slot, and the pivot post allowing the blade holder with cutting blade to rotate in approximately a circle at the end of the adjustable sliding arm, thereby defining the circular portion of the sheet of material which is cut out.



7

2. An apparatus as described in claim 1, further comprising a curve along one long interior side of the slot, wherein the provision to fix the cutting blade into the slot also presses the cutting blade against the curve, thereby forcing a curvature of the cutting blade to approximately match the curve of the side of the slot.

3. An apparatus as described in claim 2, further comprising a curve along one long interior side of the slot, wherein the provision to fix the cutting blade into the slot presses the center of the cutting blade against the curve, thereby forcing a curvature of the cutting blade to approximately match the curve of the side of the slot.

4. An apparatus as described in claim 2, further comprising approximately matching the curve of the slot with the arc of the approximately circular large hole being cut in the sheet of material.

5. An apparatus as described in claim 2, further comprising two curvatures of the side walls of the slot on opposing long interior sides of the slot, the blade holder being reversible on the adjustable sliding arm, thereby allowing a choice of two cutting blade curvatures to match two arcs of the approximately circular large hole being cut in the sheet of material.

6. An apparatus as described in claim 1, further comprising a system for adjusting the adjustable sliding arm at the pivot post, such that the distance between the pivot post center and the location of the cutting blade can be changed.

7. An apparatus as described in claim 6, further comprising guide marks on the adjustable arm such that different radii can be set for the approximately circular large hole being cut in the sheet of material.

8. An apparatus as described in claim 1, further comprising a small center hole in the center of the portion of the sheet of material which is going to be cut out, whereby the pivot post comprises a peg in the center hole.

9. An apparatus as described in claim 1, whereby the pivot post comprises a suction cup to hold the pivot post in place in the center of the portion of the sheet of material which is going to be cut out.

10. An apparatus as described in claim 1, whereby the pivot post comprises a magnetic fastener to hold the pivot post in place in the center of the portion of the sheet of material which is going to be marked.

11. An apparatus as described in claim 1, whereby the pivot post comprises a screw to hold the pivot post in place in the center of the portion of the sheet of material which is going to be marked.

12. An apparatus as described in claim 1, wherein the cutting blade consists of a vibrating blade.

13. An apparatus as described in claim 1, wherein the blade holder portion of the apparatus can be used as a depth stop for the cutting blade, thereby controlling the depth of penetration of the cutting blade through the sheet of material.

8

14. An apparatus as described in claim 1, wherein the lower horizontal surface of the blade holder portion of the apparatus is convex.

15. An apparatus as described in claim 1, wherein the lower corners of the blade holder portion of the apparatus are chamfered or rounded.

16. An apparatus for marking an approximately circular section of a sheet of material, comprising; a marking tool which employs a marking device capable of marking the sheet of material, a pivot post which is attached in the center of a portion of the sheet of material which is going to be cut out, an adjustable sliding arm connected at one end to the pivot post, the adjustable sliding arm being connected at the other end to a marking device holder, the marking device holder having an opening passing through the body of the marking device holder, the marking device holder having provision to fasten the marking device into the slot such that the marking tip of the marking device is approximately perpendicular to the opening, and the pivot post allowing the marking device holder with marking device to rotate in approximately a circle at the end of the adjustable sliding arm, thereby defining the circular portion of the sheet of material which is marked.

17. An apparatus as described in claim 16, further comprising a system for adjusting the adjustable sliding arm at the pivot post, such that the distance between the pivot post center and the location of the marking device can be changed.

18. An apparatus as described in claim 17, further comprising guide marks on the adjustable arm such that different radii can be set for the approximately circular large hole being marked on the sheet of material.

19. An apparatus as described in claim 16, further comprising a small center hole in the center of the portion of the sheet of material which is going to be marked, whereby the pivot post comprises a peg in the center hole.

20. An apparatus as described in claim 16, whereby the pivot post comprises a suction cup to hold the pivot post in place in the center of the portion of the sheet of material which is going to be marked.

21. An apparatus as described in claim 16, whereby the pivot post comprises a magnetic fastener to hold the pivot post in place in the center of the portion of the sheet of material which is going to be marked.

22. An apparatus as described in claim 16, whereby the pivot post comprises a screw to hold the pivot post in place in the center of the portion of the sheet of material which is going to be marked.

23. An apparatus as described in claim 16, wherein the lower horizontal surface of the blade holder portion of the apparatus is convex.

24. An apparatus as described in claim 16, wherein the lower corners of the blade holder portion of the apparatus are chamfered or rounded.

\* \* \* \* \*