



US006355935B1

(12) **United States Patent**
Kalley et al.

(10) **Patent No.:** **US 6,355,935 B1**
(45) **Date of Patent:** ***Mar. 12, 2002**

- (54) **PORTABLE LIGHT SOURCE AND SYSTEM FOR USE IN LEAK DETECTION**
- (75) Inventors: **Terrence D. Kalley**, Troy, MI (US); **Richard C. Cavestri**, Columbus, OH (US); **Robert L. Miniutti**, Jamestown, RI (US)
- (73) Assignee: **Bright Solutions, Inc.**, Troy, MI (US)
- (*) Notice: Subject to any disclaimer, the term of this patent is extended or adjusted under 35 U.S.C. 154(b) by 0 days.
- This patent is subject to a terminal disclaimer.
- | | | | |
|---------------|---------|--------------------|-----------|
| 4,823,242 A | 4/1989 | Maglica et al. | |
| 4,839,553 A | 6/1989 | Mellor | |
| 4,849,630 A * | 7/1989 | Fukai et al. | 250/327.2 |
| 5,207,502 A | 5/1993 | Maglica | |
| 5,226,722 A | 7/1993 | Maglica | |
| 5,260,858 A | 11/1993 | Maglica | |
| 5,315,494 A | 5/1994 | Maglica | |
| 5,349,506 A | 9/1994 | Maglica | |
| 5,390,091 A | 2/1995 | Maglica | |
| 5,440,919 A | 8/1995 | Cooper | 73/40.7 |
| 5,650,563 A | 7/1997 | Cooper et al. | 73/40.7 |
| 5,674,000 A | 10/1997 | Kalley | 362/293 |
| 5,742,066 A * | 4/1998 | Cavestri | 250/504 R |
| 5,788,364 A | 8/1998 | Cooper et al. | 362/293 |
| 5,816,692 A | 10/1998 | Cooper et al. | 362/293 |
| 5,905,268 A | 5/1999 | Garcia et al. | 250/504 R |
| 5,959,306 A * | 9/1999 | Kalley et al. | 250/504 R |
| 5,997,154 A | 12/1999 | Cooper et al. | 362/293 |

(21) Appl. No.: **09/406,871**

FOREIGN PATENT DOCUMENTS

(22) Filed: **Oct. 29, 1999**

| | | |
|----|---------|--------|
| CA | 1331372 | 8/1994 |
| CA | 2185544 | 9/1995 |

Related U.S. Application Data

OTHER PUBLICATIONS

- (63) Continuation of application No. 08/943,903, filed on Oct. 3, 1997, now Pat. No. 5,959,306, which is a continuation-in-part of application No. 08/598,434, filed on Feb. 8, 1996, now Pat. No. 5,742,066, and a continuation-in-part of application No. 08/598,435, filed on Feb. 8, 1996, now Pat. No. 5,624,000.
- (51) **Int. Cl.⁷** **G01J 1/00**
- (52) **U.S. Cl.** **250/504 R; 250/504 H**
- (58) **Field of Search** **250/504 R, 453.1, 250/504 H**

- Brochure, Tracer Products, Tracerline® TP-1700, 1995.
 Brochure, Tracer Products, Tracerline® TP-1800, 1996.
 Brochure, Tx; SupreTech, BluLite™ System, Apr., 1994.
 Brochure, Tracer Products, Tracerline® UV-Fluorescent Leak Detection, May, 1996.
 Brochure, Bright Solutions, Inc., Stay-Brite® Super-Concentrated Fluorescent A/C Leak Detection Dyes, Catalog No. 9603, 1996.

* cited by examiner

(56) **References Cited**

Primary Examiner—Bruce Anderson

(74) *Attorney, Agent, or Firm*—Fish & Richardson P.C.

U.S. PATENT DOCUMENTS

(57) **ABSTRACT**

| | | | |
|---------------|---------|-----------------|---------|
| 4,388,673 A | 6/1983 | Maglica | |
| 4,527,223 A | 7/1985 | Maglica | |
| 4,577,263 A | 3/1986 | Maglica | |
| 4,656,565 A | 4/1987 | Maglica | |
| 4,658,336 A | 4/1987 | Maglica | |
| 4,722,593 A * | 2/1988 | Shimazaki | 350/336 |
| 4,780,799 A | 10/1988 | Groh | 362/294 |
| 4,819,141 A | 4/1989 | Maglica et al. | |

A light source for examining leak detection sites in heating, ventilating, and air conditioning systems using a fluorescent dye is described. The light source can include a parabolic reflector or a low voltage lamp.

45 Claims, 4 Drawing Sheets

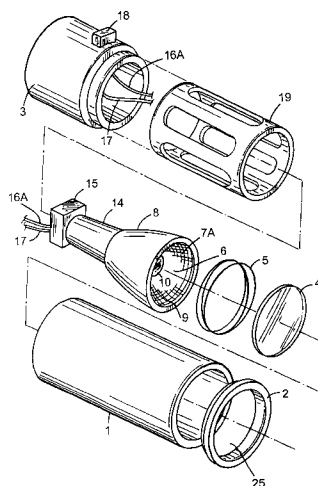

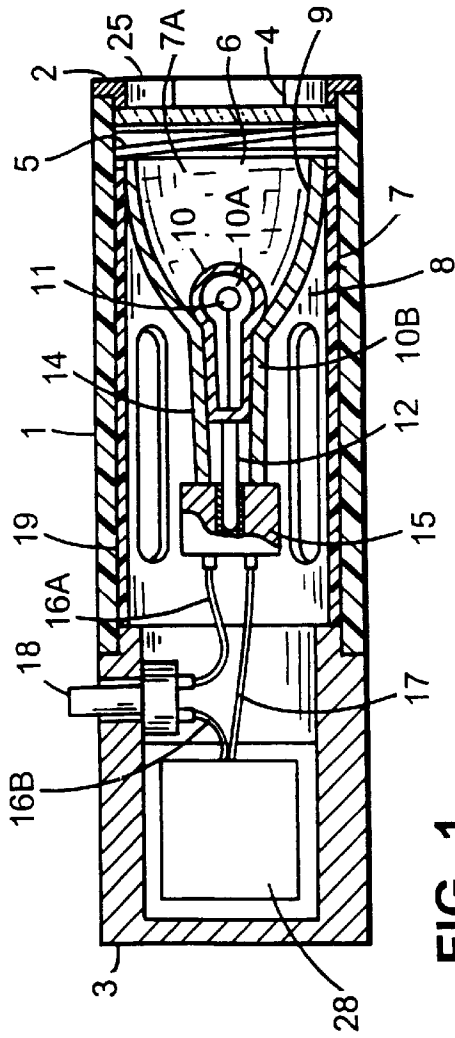

FIG. 1

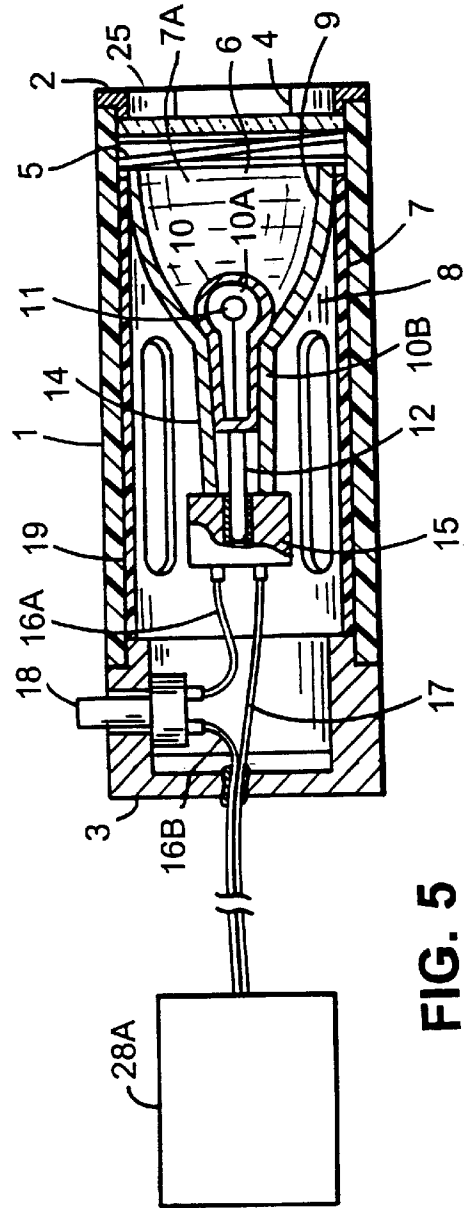

FIG. 5

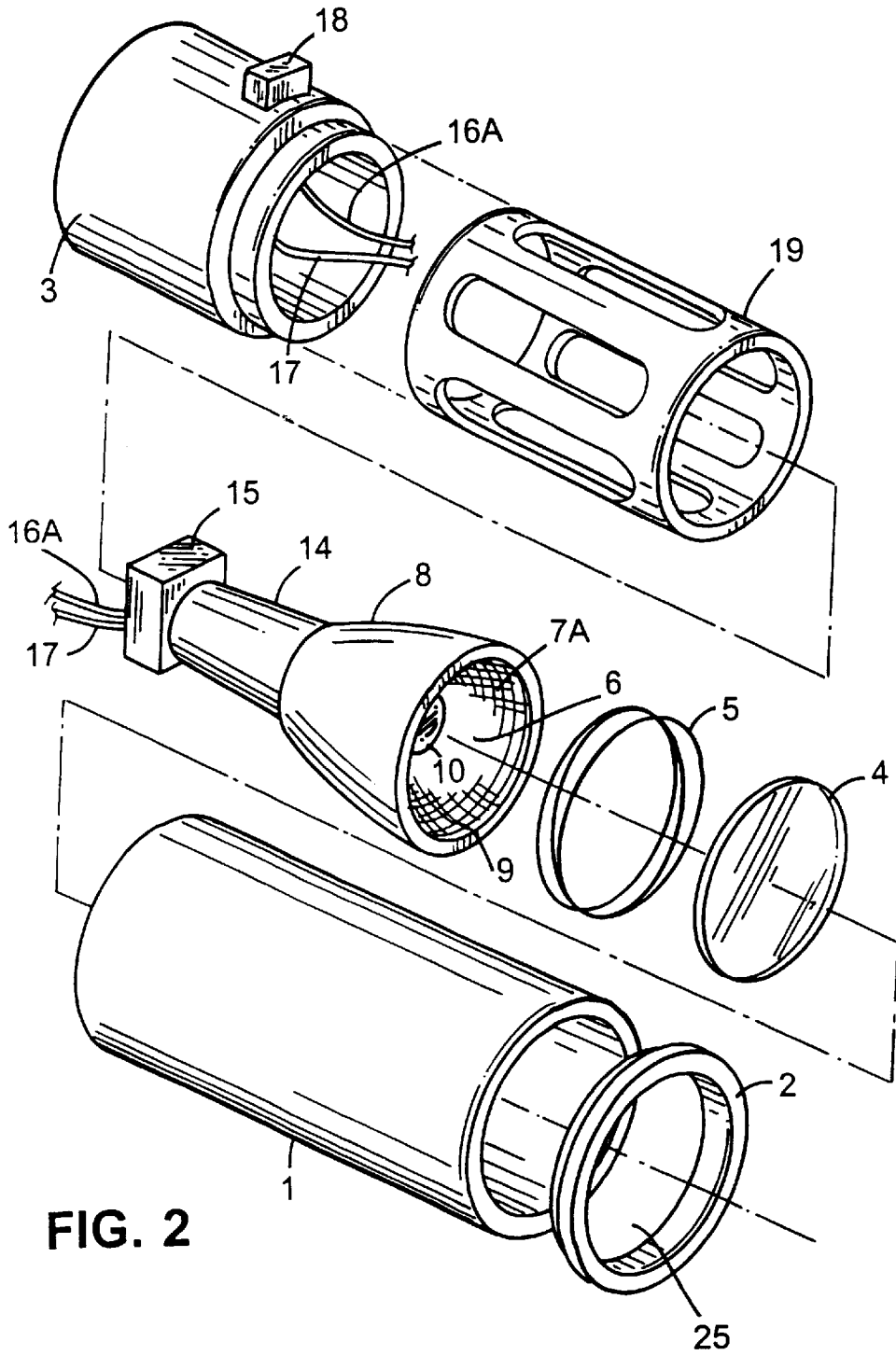

FIG. 2

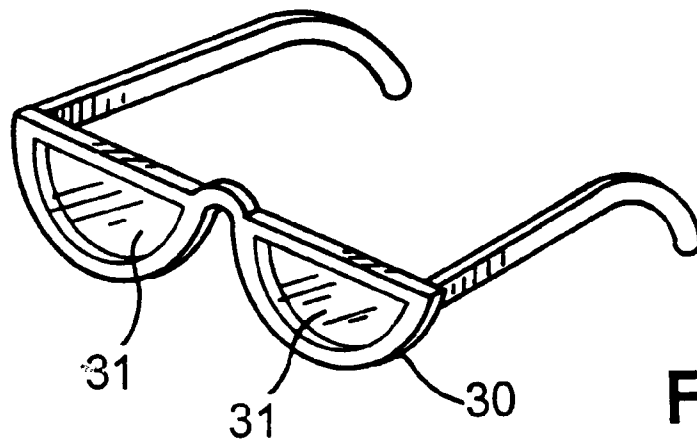

FIG. 3

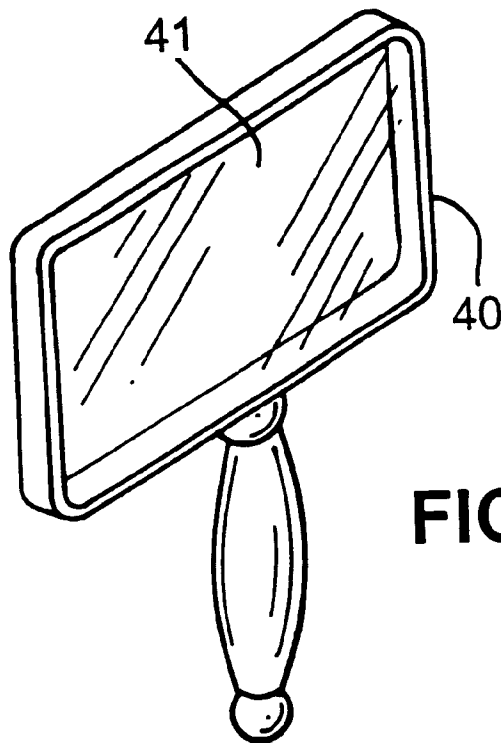

FIG. 4

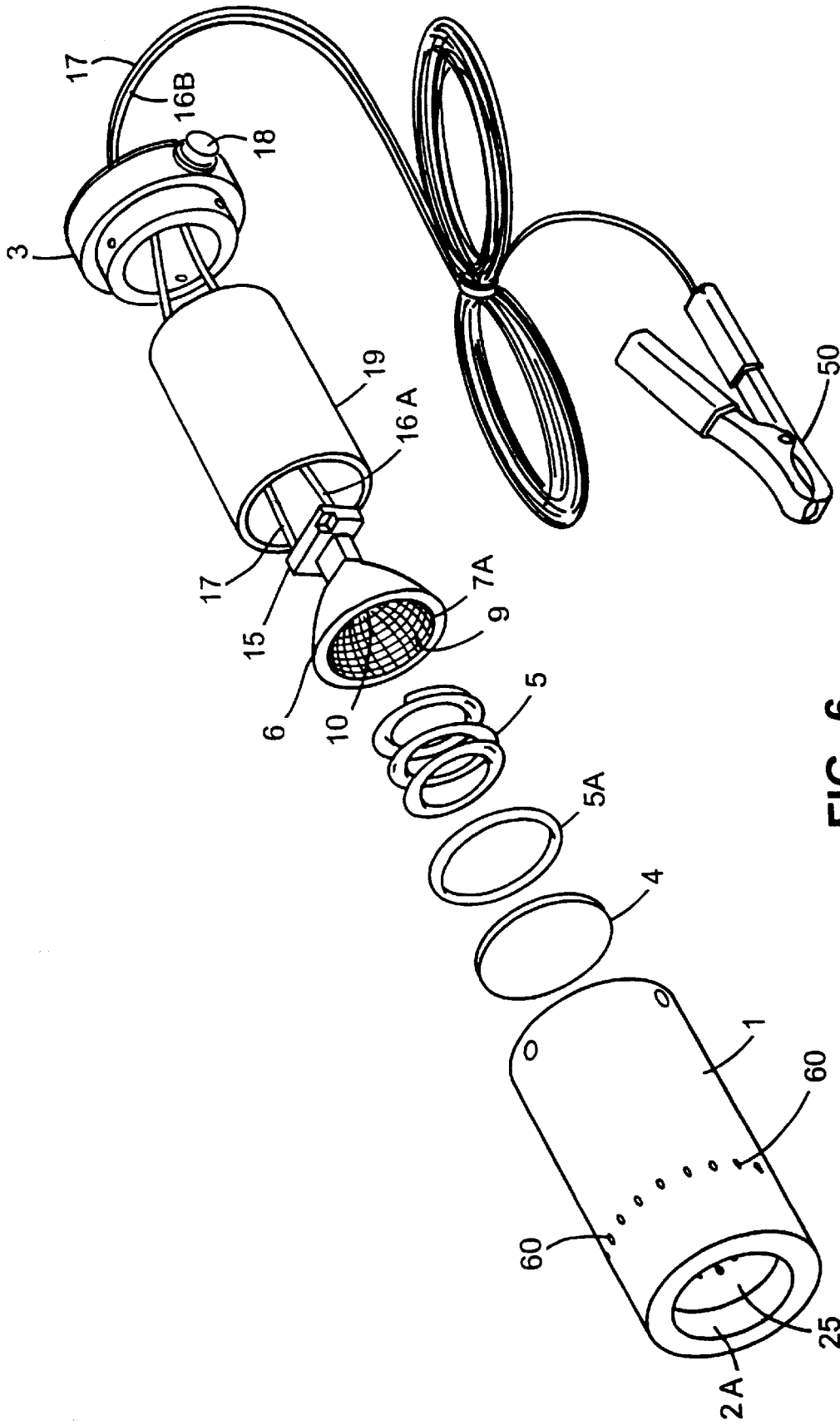

FIG. 6

PORTABLE LIGHT SOURCE AND SYSTEM FOR USE IN LEAK DETECTION

CROSS REFERENCE TO RELATED APPLICATIONS

This is a continuation of U.S. Ser. No. 08/943,903, filed Oct. 3, 1997, now U.S. Pat. No. 5,959,306, which is a continuation-in-part of application U.S. Ser. No. 08/598,434, filed Feb. 8, 1996, U.S. Pat. No. 5,742,066 and a continuation-in-part of application U.S. Ser. No. 08/598,435, filed Feb. 8, 1996 U.S. Pat. No. 5,624,000.

FIELD OF THE INVENTION

The invention relates to a light source and system for detecting leaks in fluid systems using light-emitting substances.

BACKGROUND OF THE INVENTION

Leak detection methods have been developed to analyze fluid systems (e.g., climate control systems such as heating, cooling, ventilating, and air conditioning systems, hydraulics, engine oil systems, automatic transmission systems, fuel systems, brake systems, or radiator coolant systems) using dyes. Some methods operate by adding emissive substances (e.g., fluorescent or phosphorescent dyes) to the refrigerants and/or lubricants of the fluid system. Suitable dyes include naphthalimide, perylene, thioxanthane, coumarin, or fluorescein, and derivatives thereof. Leaks can be detected by observing fluorescence of the dye at leak sites resulting from excitation of the dye with a light source having particular illumination characteristics (e.g., wavelength or intensity). Examples of leak detection methods are described in U.S. Pat. Nos. 5,357,782 and 5,421,192 which issued to Richard G. Henry on Oct. 25, 1994, and Jun. 6, 1995, respectively, both of which are assigned to the same assignee as the assignee of the present application. Similar fluorescence methods can be used in the non-destructive testing industry.

In the field of leak detection, crack detection, and related non-destructive testing, different dyes can be utilized which fluoresce at different wavelengths. Fluorescence is the emission of light at wavelengths greater than the wavelength of light emitted from the light source used to probe for leaks.

Suitable light sources for use in fluorescence detection emit light of wavelengths suitable to excite the dye and cause light emission. The visibility of the fluorescence from the dye can be increased when the leaks are illuminated with light having a wavelength between 300 and 700 nanometers. In general, the dyes fluoresce brightly when excited by light sources which emit light in the 300 to 500 nanometer range.

Typical light sources used in these types of applications include alternating current lamps operating on either 110 to 220 volts, such as the PAR 38, manufactured by Phillips. These lamps had power outputs in the 100 to 200 watt range and produced a substantial amount of light outside of the wavelength range desired to produce a good fluorescence signal. These lamps also tend to create a large amount of heat and required the use of a ballast which provided additional bulk and weight. Self-ballasted lamps were also developed that generally had relatively long warm-up periods and were very sensitive to voltage surges.

SUMMARY OF THE INVENTION

In general, the invention features a light source that is small, portable, and light weight. The light source produces

a collimated beam of light. The light source produces a high output of light having a wavelength that can effectively excite emissive substances used in leak detection systems. The light source can have a parabolic reflector and can have a low-voltage lamp.

In one aspect, the invention features a light source for examination of a substance which emits light at a wavelength greater than a wavelength of light emitted from the light source when the substance is excited by the wavelength of light emitted from the light source. The light source includes a housing having a light outlet, a reflector located within the housing, a lamp positioned in the housing between the reflector and light outlet, and a filter positioned in the housing between the lamp and the light outlet. Accordingly, the wavelength of the light emitted from the light source through the light outlet is restricted to a predetermined range effective to enhance the detection of emission of light from a substance when the substance is excited by the wavelength of light emitted from the light source. The preferred lamp is a low-voltage lamp (e.g., a halogen lamp). The preferred reflector is a parabolic reflector.

The filter restricts the wavelengths of light emitted from the lamp and the light reflected by the reflector. The filter can be an absorption filter, dichroic filter, or other interference filter. The filter can be part of the glass that surrounds the element of the lamp.

The light source produces a light power density in the ultraviolet wavelength region of at least 0.1 mW/cm² at a distance of two feet from the light outlet or a light power density in the blue wavelength region of at least 0.75 mW/cm² at a distance of two feet from the light outlet.

The lamp is capable of being connected to a source of electrical power, such as a battery, battery pack, or transformer. The reflector can be a dichroic reflector. The reflector can have a faceted surface or a smooth surface. The reflector can substantially reflect a selected wavelength of the light emitted from the lamp. For example, the reflector can reflect light primarily in the blue wavelength range, in the ultraviolet wavelength range, or in the blue and ultraviolet wavelength ranges.

In another aspect, the invention features a system for detecting leaks in fluid systems. The system includes a substance capable of emitting an emission wavelength of light after being excited by an excitation wavelength of light, and the light source, which is capable of emitting the excitation wavelength of light.

In another aspect, the invention features a method of detecting a leak in a system containing a substance capable of emitting an emission wavelength of light after being excited by an excitation wavelength of light. The method includes the steps of providing a collimated beam of light at the excitation wavelength from a light source to a leak site, and detecting emission of light from the substance. The substance and the light source can be provided in a single package. The substance can be added to the system.

The substance can be an emissive leak detection dye, such as a naphthalimide, perylene, thioxanthine, coumarin, fluorescein, or other fluorescent or phosphorescent dye.

The system can include a filter lens for detecting the emission wavelength of light, where the emission wavelength of light emitted is enhanced by the utilization of filter lens by an observer of the emission wavelength. The filter lens can be incorporated in eyewear or a shield. The shield can be hand-held or mounted directly on the light source. When mounted on the light source, the observer can view the emission wavelength through the mounted filter lens.

The low-voltage lamp can be a high color temperature, low voltage bulb, such as, for example, a quartz halogen-xenon bulb. Small, direct current lamps of the halogen type, or similar lamps rich in gases such as xenon require no ballast, are small in dimension, are light weight, and are typically not subject to voltage surges or spiking. The low-voltage lamps provide portability.

The low-voltage lamp can be powered by batteries (e.g., 4.5V, 6V, 9V, or 12V batteries) or battery packs. The batteries or battery packs can be rechargeable. In other embodiments, the low-voltage lamp can be powered by a transformer.

Reflectors can be used to adjust the output wavelengths of light from the low-voltage lamp so that sufficient light power density (i.e., candle power density) reaches the emissive substance. The light source can include an essentially parabolic reflector. The parabolic shape of the reflector geometry can create a collimated beam consisting of parallel beams of light. The collimated beam can provide a relatively constant illumination intensity over the leak detection area.

The parabolic reflector has a three-dimensional paraboloid shape. A lengthwise cross-section of a parabolic reflector reveals a parabolic shape having a focal point or a focal region. In a parabolic reflector, light rays emanating from the focal point or region are reflected by the surface of the paraboloid in a direction essentially parallel (e.g., over the distance to the leak site) to the lengthwise axis of the reflector to form the collimated beam. Because the rays are parallel, they do not noticeably diverge or converge with distance. As a result, the energy density of the light is relatively constant at short (e.g., 1 foot), medium (e.g., 3-5 feet) and long distances (e.g., up to about 100 feet) from the lamp.

The paraboloid can be described by the formula

$$Z=(X^2+Y^2)/2R$$

where Z is the lengthwise axis, X and Y are the perpendicular Cartesian axes, and R represents the focal point. The focal point can be between about 0.005 inches and about 2.00 inches, preferably between about 0.01 inches and about 1.50 inches. The lengthwise axis can be between about 0.3 inches and about 8 inches, preferably between about 0.5 inches and 6 inches. The corresponding diameter of the paraboloid is between about 0.50 inches and about 8 inches, preferably between about 0.75 inches and about 3 inches. The lamp is located at or near the focal point.

The reflector can have faceted or smooth surfaces to further modify light distribution. The faceted arrangement can improve the distribution of the light, or can smooth or break up light-dark edges. Facets on the surfaces of the reflector can range from fine, scarcely visible grains to clearly visible faceting, with the effect being correspondingly less or more pronounced.

The reflectors can be metal (e.g., aluminum), glass, or plastic. The glass or plastic reflectors can be coated (e.g., with a metal) to obtain the particular reflective properties. The coatings can be applied, for example, by vapor deposition or plating.

Detection of fluorescence can be enhanced when the wavelength of the light emitted from the light source is restricted so that little or no light of the emission wavelength comes from the light source (e.g., little or no light beyond the excitation wavelength, extending into the visible region). The wavelength of the light emitted from the light source can be controlled by use of reflectors with faceted surfaces

or dichroic coatings. The wavelength can be further influenced by passing the light through a filter before it exits the light source.

Dichroic coatings produce their reflection properties through the phenomenon of interference. The dichroic coatings consist of multiple (e.g., up to several dozen) thin layers, each only a quarter of a wavelength of the light thick, alternating between materials of a high and low refractive index. Fine tuning of the thicknesses of the layers and the way they are combined enable virtually any reflection curve to be created. The maximum reflectivity is nearly 100%, and there is virtually no absorption of radiation in the regions of low reflectivity. Accordingly, dichroic reflectors are substantially loss-free; the light that is not reflected is passed through the reflector or absorbed by the reflector.

Among the best known members of the dichroic family are the cold-light reflectors which reflect visible light between about 300 and 750 nanometers and allow radiated heat to pass unhindered through the glass. This arrangement greatly reduces thermal load on the illuminated surface or object. The reflectors can reflect the blue wavelength range and/or the ultraviolet wavelength range. In the case of the blue-light reflector, only the blue wavelength range of the spectrum (e.g., between 400 and 500 nanometers) is reflected. In the case of the ultraviolet reflector, only the ultraviolet wavelength range (e.g., between about 300 and 400 nanometers) emitted by the lamp is reflected.

Cold-light reflectors can excite emissive substances well since many emissive substances are excited by light in the wavelength range that is reflected by cold-light reflectors (i.e., 300 to 500 nanometers). Some white-light reflectors can excite emissive substances well since many emissive substances can be excited by light in the wavelength range that is reflected by the white-light reflectors (i.e., 400 to 700 nanometers). Light produced above these ranges is largely wasted since it may not produce the desired emission, produces additional heat, and can detract from the ability of an observer to see the emission wavelength. Thus, dichroic reflectors and faceted reflectors, which have narrow bandwidths of reflected light output can be used to provide proper excitation wavelengths for emissive substances and provide a precision not possible using other types of reflectors.

Lamps can also be effective at providing the wavelength range required to observe emission by providing strong intensities of light. In general, the narrower the beam spread, the greater the light power density (e.g., candle power per unit area; mW/cm²) and the greater the intensity of created emission.

It is also possible to narrow the spectral output from reflector lamps by utilizing filters. Filters can be an integral part of the reflector unit or can be independent of the reflector lamp but used in conjunction with it.

In general, light output from the reflector and lamp is reduced to pass only the desired wavelength or wavelength range for the application. Optical filters can also be used for safety purposes. Suitable filters include absorption filters, dichroic filters, or interference filters. The dichroic filters operate on the principal of interference. These filters were designed to transmit the wavelength of light which can excite the emissive substance, for example, at the site of a leak (i.e., light in the blue wavelength range or ultraviolet wavelength range).

Suitable light sources can be identified by testing the average light power density of the light in the desired spectral region for excitation at fixed distances from the light outlet (e.g., at one foot, three foot, and five foot distances). The average light power density is measured using a detec-

tor that detects light in the excitation region (e.g., a 320–400 nm detector or a 400–500 nm detector). The detector can be a radiometer such as M007-004 or a blue hazard probe such as M007-027, available from UV Process Supply, Inc. A suitable light source has an average light power density in the ultraviolet wavelength region of at least 0.1 mW/cm² (e.g., between 0.2 mW/cm² and 1 mW/cm²) or in the blue wavelength region of at least 0.75 mW/cm² (e.g., between 1 mW/cm² and 50 mW/cm², preferably between 5 mW/cm² and 20 mW/cm²) at a distance of two feet or more (e.g., three feet or five feet) from the light outlet.

Additionally, it may be possible to further enhance the detection of fluorescence by observing the fluorescence through a filter lens. The filter lens can be part of a shield or eyewear used by the user of a fluorescence leak detection system. The filter lens permits only light of certain wavelengths (e.g., the emission wavelength, but not the excitation wavelength) to pass and to be detected by the user. The filter lens can take several forms, including eyewear (e.g., glasses, or goggles), or shields (e.g., face shields). The filter lens can be designed to reduce or eliminate exposure of the observer to damaging ultraviolet radiation. Thus, the filter lens, when used in combination with filters, can lead to enhanced detection of fluorescence.

Additional features and advantages of the invention will become apparent from the detailed description of the preferred embodiments of the invention.

BRIEF DESCRIPTION OF THE DRAWINGS

FIG. 1 is a drawing depicting a sectional view of one embodiment of a light source having parabolic reflector for examining substances which emit light at a wavelength greater than the wavelength of light emitted from the light source which excites the substance.

FIG. 2 is a drawing depicting an exploded view of one embodiment of a light source having a parabolic reflector.

FIG. 3 is a drawing depicting a perspective view of eyewear including long wavelength pass material for use in conjunction with a light source.

FIG. 4 is a drawing depicting a perspective view of a face shield including long wavelength pass material for use in conjunction with a light source.

FIG. 5 is a drawing depicting a sectional view of a light source having parabolic reflector and a battery pack.

FIG. 6 is a drawing depicting an exploded view of an alternative embodiment of a light source having a parabolic reflector.

DETAILED DESCRIPTION OF THE PREFERRED EMBODIMENTS

Referring to FIGS. 1, 2 and 5, one embodiment of the light source consists of housing 1, which can be constructed of phenolic resin, plastic, or other suitable material. The unit is cylindrical in construction and hollow and has affixed at either end thereto front cap 2 and rear cap 3. Both caps can be constructed of aluminum or other suitable materials.

Front cap 2 includes light outlet 25 which allows light to exit from the light source. Front cap 2 has positioned directly behind it filter 4, such as, for example, a BSI lens filter, No. PS-600. This particular filter provides maximum transmission of light at a wavelength of approximately 400 nanometers, wherein about 82% of the light at that wavelength is transmitted through the filter lens. The filter can be made of glass. The filter generally transmits light in a wavelength range shorter than the emission wavelength of

the emissive substance. In embodiments, the filter has a flat or a lens shape.

Located directly behind the filter 4 is compression spring 5 which aids in positioning the filter and reflector 6 in proper spatial relationship within the housing and further provides some shock-absorbing assistance.

Reflector 6 is a parabolic reflector. Reflector 6, located behind filter 4 and separated by compression spring 5, is a molded glass reflector, metal plated plastic reflector, or a polished metal reflector. The reflector can be a dichroic reflector or have a faceted surface. In certain embodiments, the reflector can be faceted and have a dichroic coating on its surface. The reflector can be a cold-light reflector. The parabolic reflector can be machined from metal (e.g., aluminum) or molded from glass or plastic. The surface of the reflector is polished. Suitable metal reflectors can be prepared from spun metal created off a parabolic mandrel. Alternatively, metal reflectors can be machined from an aluminum block. The inner surface is polished to create a highly reflective surface. Suitable plastic reflectors can be prepared by injection molding a plastic piece in a paraboloid form followed by deposition of metal onto the plastic to form a reflective surface. A glass reflector can be prepared by molding. A dichroic surface can be formed on the glass surface by sequential deposition of the interference layers.

The reflector has a reflective front surface 9. The surface can be configured to reflect visible light from the reflector. The surface can transmit heat through the reflector. The front surface 9 can be provided with facets 7A, while providing a uniform beam of illumination from lamp 10. Alternatively, front surface 9 can be smooth.

Lamp 10 and reflector 6 are chosen to provide a collimated beam. Extending from back surface 8 of reflector 6 is mounting portion 14. Lamp 10 is mounted in mounting portion 14 with the filament portion 10A extending beyond the front surface 9 of reflector 6. Lamp 10 has a filament portion 10A and a neck portion 10B. Included therein is filament 11, which is connected at its rear to terminal 12 and terminal 13 (not shown). (Terminal 13 is not visible in the view because it is parallel to terminal 12.)

Lamp 10 is aligned in the parabolic reflector to maximize the collimated nature of the light beam, so that a tightly collimated beam with a high light density can be produced. The position of the lamp in the reflector is adjusted so that the light from the lamp emanates from the area nearest the focal point of the paraboloid. For example, a target (consisting of concentric circles with cross hairs along the X and Y axes of the circles) is placed on a wall. The lamp is inserted into the reflector and the power is turned on so that the light strikes the target. The size of the beam on the target is noted. The position of the lamp in the reflector is incrementally adjusted until the size of the beam on the target is minimized. This position indicates the highest degree of collimation and optimum alignment.

Socket 15 receives terminals 12 and 13 provides connections to circuit conductors 16 and 17. Socket 15 is constructed of ceramic or similar material. Conductor portion 16A extends to on/off switch 18 and continues through conductor portion 16B to internal battery 28 or external battery pack 28A. The other conductor 17 extends directly from socket 15 to battery 28 or battery pack 28A.

The lamp, as described herein, typically operates from a source having a voltage of 12V or less. Preferably, the low-voltage lamp is a 4.5V, 6V, or 12V lamp. The lamp can draw, for example, approximately 20 watts of power using a 6V power source. The low-voltage lamp can be a high

color temperature, low voltage bulb, such as, for example, a quartz halogen-xenon bulb. A high color temperature is a color temperature greater than 2600° K., preferably greater than 2900° K., more preferably greater than 3000° K., and most preferably greater than 3100° K. Suitable low-voltage lamps include, for example, 12V lamps XENOPHOT HLX 64610 (Sylvania) or PR-120 (JKL), 6V lamps XENOPHOT HLX 64250 (Sylvania), PSI-X631-LP (PSI) or PR-140 (JKL), and 4.5V lamps PSI-X4531-ELP (PSI) or PR-90 (JKL).

Lamp **10** can be bonded to mounting portion **14** by means of a suitable adhesive, such as a silicon or epoxy based adhesive. Assemblies having both the lamp and reflector include 50MR160Q12NSP (12V, Sylvania), FRB 35MR16Q/8/NSP (Sylvania), 419905P AR-70 (Osram), PSI-RP30 (parabolic reflector, PSI), and PSI-RP20 (parabolic reflector, PSI).

The power source can consist of a battery **28**, set of batteries, or battery pack **28A**. The battery or battery pack can be disposable or rechargeable batteries. Alternatively, the power source can be a transformer that steps a 110V or 220V source down to a low-voltage suitable to power the low-voltage lamp.

Switch **18** is utilized to turn the light source on or off during usage of the present novel light source to permit detection of the substances which emit light at wavelengths greater than the wavelength of the light emitted from the light source used to excite the substance.

Heat shield **19** extends around the rear portion of reflector **6**, mounting portion **14**, and socket **15**, and is held in place against the rear of reflector **6** by means of portions of rear cap **3**. The heat shield assists in transmitting excess heat through the back surface **8** and neck portion **14** of reflector **6**, which render the lamp assembly comfortable to the touch during operation.

Referring to FIGS. **3** and **4**, detection of light emitted from the substance can be enhanced by viewing the fluorescence through filter lens **31** or **41**. The filter lens can be a long wavelength pang material which reduces the amount of short wavelength light (e.g., the excitation wavelength) observed by the user or detector. In particular, filter lens **31** or **41** restricts the detection of wavelengths of light emitted from the light source. The filter lens permits only light of certain wavelengths (e.g., the emission wavelength) to pass and to be detected by the user. The filter lens can be housed in a shield **40** or eyewear **30**. In embodiments, the filter lens allows wavelengths greater than the excitation wavelength to be observed.

Referring to FIG. **6**, another embodiment of the light source consists of housing **1**, is cylindrical in construction and has front lip **2A** and rear cap **3**. Front lip **2A** includes light outlet **25** which allows light to exit from the light source. Housing **1** has vents **60** that allow heat to escape from the light source. Filter **4** is positioned directly behind front lip **2A**. O-ring **5A** and compression spring **5** are positioned behind filter **4** to which aides in positioning filter **4** and reflector **6** in proper spatial relationship within the housing and can provide cushioning.

Reflector **6** is a parabolic reflector, located behind filter lens **4**. The reflector has a reflective front surface **9** and can be provided with facets **7A**. Lamp **10** is located within the reflector. Heat shield **19** extends around the rear portion of reflector **6**, mounting portion **14**, and socket **15**, and is held in place against the rear of reflector **6** by means of portions of rear cap **3**.

Lamp **10** and reflector **6** are chosen to provide a collimated beam. Lamp **10** is connected to socket **15**, which

provides connections to circuit conductors **16A** and **17**. Conductor portion **16A** extends to switch **18** and continues through conductor portion **16B** to a power source. For example, conductors **16B** and **17** can be connected to clip **50** that can be attached to a transformer or battery.

Other embodiments are within the claims.

What is claimed is:

1. A light source for examination of a substance which emits light at a wavelength greater than a wavelength of light emitted from the light source when the substance is excited by the wavelength of light emitted from the light source, the light source comprising:

a housing having a light outlet;

a lamp positioned in the housing; and

a dichroic filter positioned in the housing between the lamp and the light outlet, wherein the filter restricts the wavelengths of light emitted from the lamp so that the wavelengths of the light emitted from the light source through the light outlet is within a predetermined range effective to enhance the detection of emission of light from a substance when the substance is excited by the wavelength of light emitted from the light source.

2. The light source of claim **1**, wherein the lamp includes an essentially parabolic reflector located within the housing, the lamp being positioned between the reflector and the light outlet.

3. The light source of claim **2**, wherein the reflector is a dichroic reflector.

4. The light source of claim **2**, wherein the reflector includes a faceted surface.

5. The light source of claim **2**, wherein the reflector includes a smooth surface.

6. The light source of claim **2**, wherein the reflector reflects light primarily in the blue wavelength range.

7. The light source of claim **2**, wherein the reflector reflects light primarily in the ultraviolet wavelength range.

8. The light source of claim **1**, wherein the lamp is a low voltage lamp.

9. The light source of claim **1**, wherein the wavelengths of light emitted from the light source is substantially between 300 and 750 nanometers.

10. The light source of claim **1**, wherein the wavelengths of light emitted from the light source is substantially between 300 and 500 nanometers.

11. The light source of claim **1**, wherein the lamp is connected to a source of electrical power and the source of electrical power is a battery pack.

12. The light source of claim **11**, wherein the battery pack is rechargeable.

13. The light source of claim **1**, wherein the lamp is connected to a source of electrical power and the source of electrical power is a battery.

14. The light source of claim **13**, wherein the battery is rechargeable.

15. The light source of claim **1**, wherein the lamp is connected to a source of electrical power and the source of electrical power is a transformer.

16. The light source of claim **1**, wherein the light source produces an average light power density in the ultraviolet wavelength region of at least 0.1 mW/cm² at a distance of two feet from the light outlet.

17. The light source of claim **1**, wherein the light source produces an average light power density in the blue wavelength region of at least 0.75 mW/cm² at a distance of two feet from the light outlet.

18. The light source of claim **1**, wherein the light source further includes a filter lens mounted on the housing.

19. A light source for examination of a substance which emits light at a wavelength greater than a wavelength of light emitted from the light source when the substance is excited by the wavelength of light emitted from the light source, the light source comprising:

- a housing having a light outlet;
- an essentially parabolic reflector located within the housing;
- a low-voltage lamp positioned in the housing between the reflector and the light outlet,; and
- a dichroic filter positioned in the housing between the lamp and the light outlet, wherein the filter restricts the wavelengths of light emitted from the lamp and the light reflected by the reflector so that the wavelengths of the light emitted from the light source through the light outlet is within a predetermined range effective to enhance the detection of emission of light from a substance when the substance is excited by the wavelength of light emitted from the light source.

20. The light source of claim 19, wherein the reflector is a dichroic reflector.

21. The light source of claim 19, wherein the reflector reflects light primarily in the blue wavelength range.

22. The light source of claim 19, wherein the reflector reflects light primarily in the ultraviolet wavelength range.

23. The light source of claim 19, wherein light source produces an average light power density in the ultraviolet wavelength region of at least 0.1 mW/cm² at a distance of two feet from the light outlet or an average light power density in the blue wavelength region of at least 0.75 mW/cm² at a distance of two feet from the light outlet.

24. The light source of claim 19, wherein the wavelengths of light emitted from the light source is between 300 and 500 nanometers.

25. The light source of claim 19, wherein the lamp is connected to a source of electrical power and the source of electrical power includes a battery.

26. The light source of claim 25, wherein the battery is rechargeable.

27. The light source of claim 19, wherein the reflector includes a faceted surface.

28. A system for detecting leaks in a fluid system, said system comprising:

- a substance for emitting an emission wavelength of light after being excited by an excitation wavelength of light; and
- a light source for emitting the excitation wavelength of light, the light source comprising:
 - a housing having a light outlet;
 - a lamp positioned in the housing; and
 - a dichroic filter positioned in the housing between the lamp and the light outlet, wherein the filter restricts the wavelengths of light emitted from the lamp so that the wavelengths of the light emitted from the light source through the light outlet is within a predetermined range including an excitation wavelength effective to enhance detection of the emission

wavelength of light from a substance when the substance is excited by the excitation wavelength.

29. The system of claim 28, wherein the lamp includes a reflector located within the housing, the lamp positioned between the reflector and the light outlet.

30. The system of claim 29, wherein the reflector is essentially parabolic.

31. The system of claim 28, wherein the substance is an leak detection dye.

32. The system of claim 28, wherein the dye is a naphthalimide, perylene, thioxanthane, coumarin, or fluorescein.

33. The system of claim 28, wherein the system further includes a filter lens for detecting the emission wavelength of light, the emission wavelength of light emitted being enhanced by the utilization of the filter lens by a user of the filter lens.

34. The system of claim 33, wherein the filter lens is incorporated in eyewear.

35. The system of claim 33, wherein the filter lens is incorporated in a shield.

36. The system of claim 33, wherein the filter lens is attached to the housing of the light source.

37. The system of claim 33, wherein the filter lens includes a long wavelength pass material.

38. The system of claim 28, wherein the lamp is connected to a source of electrical power.

39. The system of claim 38, wherein the source of electrical power includes a battery.

40. The system of claim 39, wherein the battery is rechargeable.

41. A method of detecting a leak in a system containing a substance capable of emitting an emission wavelength of light after being excited by an excitation wavelength of light, the method comprising:

- providing light within a predetermined range from a light source to a leak site, the light passing through a dichroic filter before exiting the light source; and
- detecting emission of light from the substance.

42. The method of claim 41, wherein the light source includes a parabolic reflector.

43. A method for detecting leaks in a fluid system comprising:

- providing a light source capable of emitting an excitation wavelength of light;
- exposing the fluid system containing a substance capable of emitting an emission wavelength after being excited by an excitation wavelength of light to the excitation wavelength from the light source; and
- observing the fluid system for the emission wavelength through a filter lens to enhance detection of the emission wavelength.

44. The method of claim 43, wherein the filter lens comprises eyewear.

45. The method of claim 43, wherein the filter lens comprises a shield in a housing.

UNITED STATES PATENT AND TRADEMARK OFFICE
CERTIFICATE OF CORRECTION

PATENT NO. : 6,355,935 B1
DATED : March 12, 2002
INVENTOR(S) : Terrence D. Kalley et al.

Page 1 of 1

It is certified that error appears in the above-identified patent and that said Letters Patent is hereby corrected as shown below:

Title page.

Item [22], remove “**Oct. 29, 1999**” and insert -- **Sept. 28, 1999.** --

Signed and Sealed this

Twenty-fourth Day of June, 2003

A handwritten signature in black ink, appearing to read "James E. Rogan", written over a horizontal line.

JAMES E. ROGAN
Director of the United States Patent and Trademark Office