



US006196343B1

(12) **United States Patent**  
**Strautnieks**

(10) **Patent No.:** **US 6,196,343 B1**  
(45) **Date of Patent:** **Mar. 6, 2001**

(54) **MID-WHEEL DRIVE WHEELCHAIR**

5,848,658 \* 12/1998 Pulver ..... 180/907  
5,944,131 \* 8/1999 Schaffner et al. .... 180/907

(75) Inventor: **Maris Strautnieks**, Woodcroft (AU)

\* cited by examiner

(73) Assignee: **Rollerchair Pty Ltd.**, South Australia (AU)

*Primary Examiner*—Kenneth R. Rice

(74) *Attorney, Agent, or Firm*—Klauber & Jackson

(\*) Notice: Subject to any disclaimer, the term of this patent is extended or adjusted under 35 U.S.C. 154(b) by 0 days.

(57) **ABSTRACT**

The invention provides a mid-wheel drive wheelchair assembly (10) which includes a central base frame (11), a seat frame (12) removably attached to the base frame (11), a pair of transversely spaced leading pivot arms (13, 14) pivotally attached to opposite sides of the base frame respectively for pivotal movement about a common transverse pivot axis (17), a pair of ground engaging mid-drive wheels (19, 20) each mounted adjacent the trailing end of a respective side pivot arm (13, 14), a pair of ground engaging front castor wheels (21, 22) rotatably mounted at the leading ends of the pivot arms (13, 14), and a pair of ground engage rear castor wheels (23, 24) rotatably mounted at opposite ends of a rigid transverse port arm (25) which itself is pivotally mounted to the rear of the base frame (11) centrally thereof. Each of the pivot arms (13, 14) is spring mounted with respect to the base frame by means of coil springs (28, 29) arranged so that any pivotal movement of the arms is cushioned by the coil springs.

(21) Appl. No.: **09/426,369**

(22) Filed: **Oct. 25, 1999**

(30) **Foreign Application Priority Data**

Oct. 23, 1998 (AU) ..... PP6704

(51) **Int. Cl.**<sup>7</sup> ..... **B62D 61/10**

(52) **U.S. Cl.** ..... **180/22; 180/907**

(58) **Field of Search** ..... 180/22, 907

(56) **References Cited**

**U.S. PATENT DOCUMENTS**

3,917,312 11/1975 Rodaway ..... 280/250.1  
4,861,056 8/1989 Duffy, Jr. et al. .... 280/250.1  
5,435,404 \* 7/1995 Garin, III ..... 180/907  
5,540,297 7/1996 Meier ..... 180/65.5

**8 Claims, 4 Drawing Sheets**

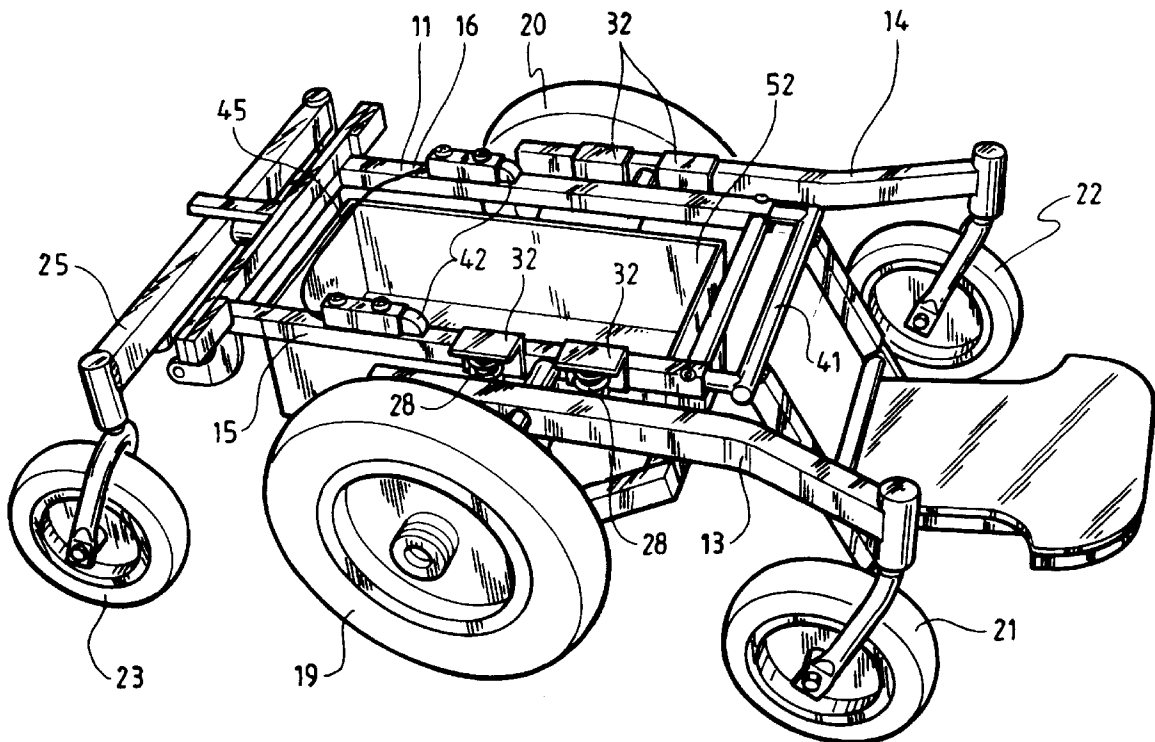

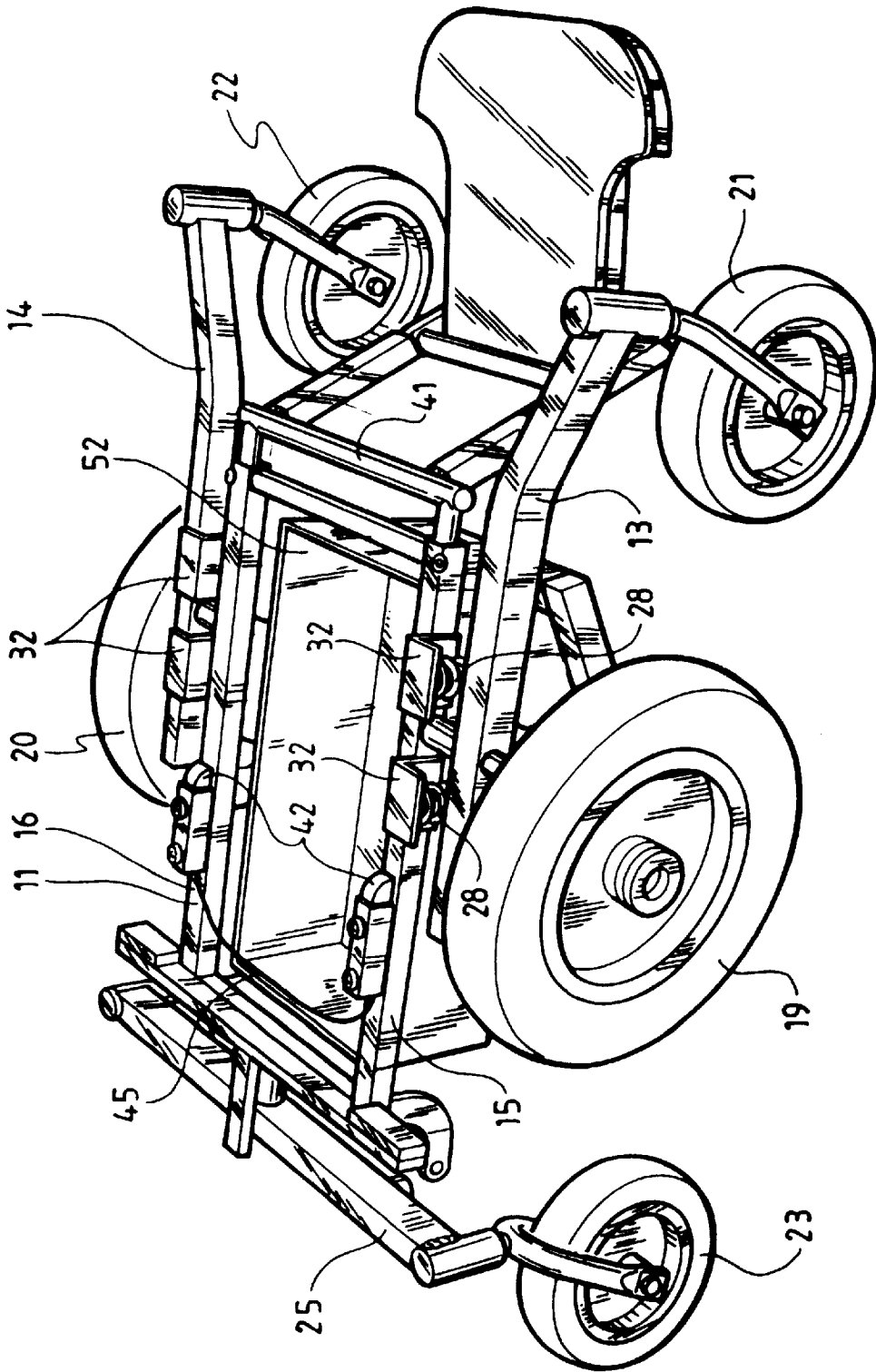

FIG 1

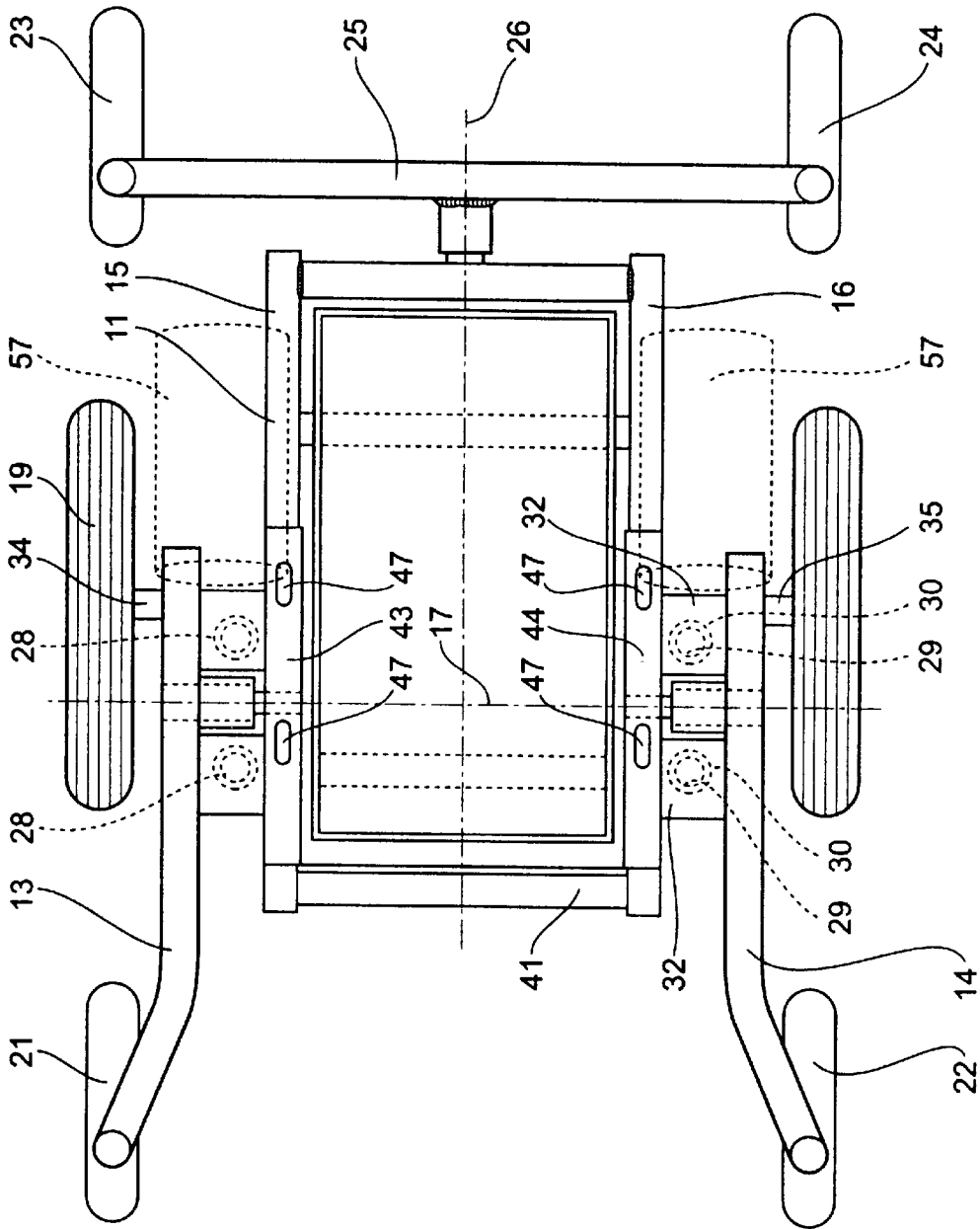

FIG 2

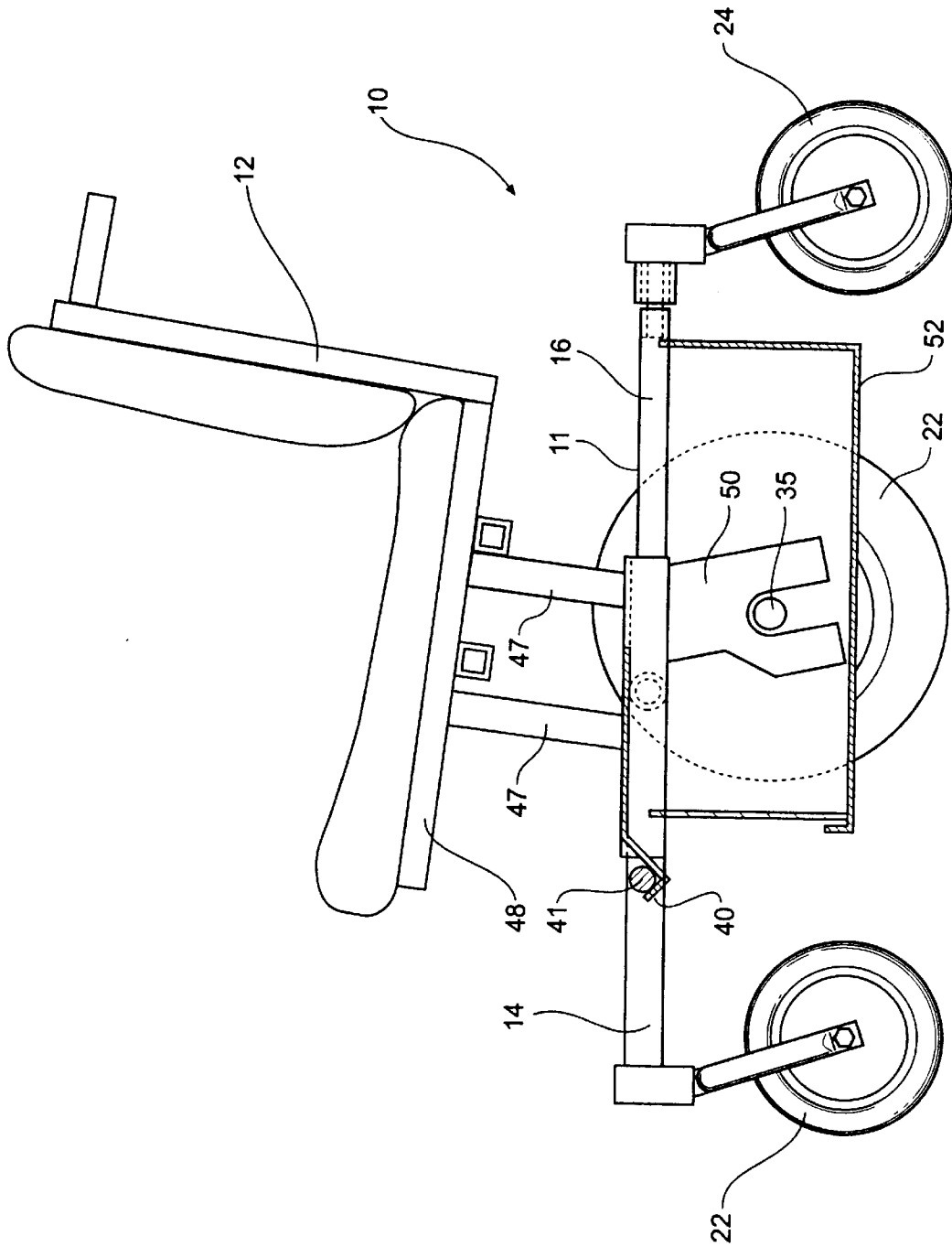
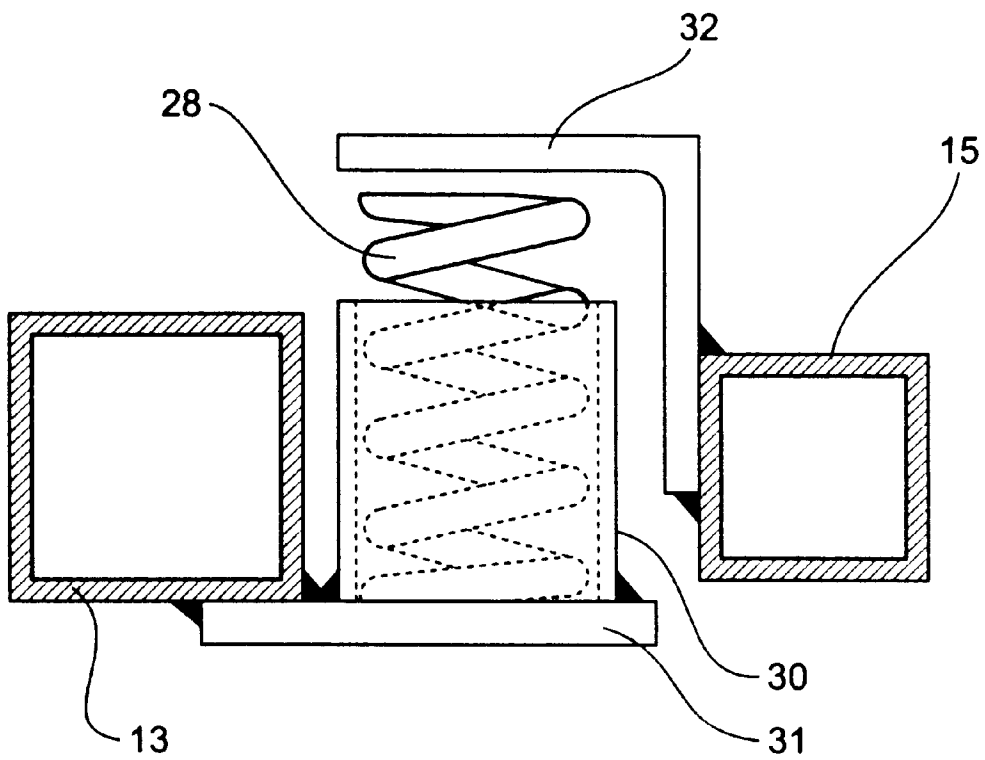

FIG 3



**FIG 4**

## MID-WHEEL DRIVE WHEELCHAIR

This invention relates generally to wheelchairs, and in particular to an improved mid-wheel drive wheelchair which incorporates a novel suspension structure.

Wheelchairs have in the past been designed with various types of suspensions for the purpose of improving passenger comfort and ride during travel over uneven surfaces. While there has been emphasis on the design of the actual seating arrangement for improving passenger comfort and ride, very little attention has been given to the suspension system for the wheelchair, nor its manoeuvrability in confined areas.

One of the problems for occupants of wheelchairs is the severe shock vibrations that are transmitted from the wheels of the wheelchair through its frame to the seat when the wheelchair travels across uneven terrain thereby causing discomfort to the wheelchair occupant. In some cases, riding the wheelchair over such terrain can be quite dangerous and often results in the wheelchair toppling over.

Several attempts have been made to improve the suspension of wheelchairs, and one example of this is to independently spring each of the rear wheels to the underframe of the wheelchair. Another example employs independent shock absorber suspensions for the rear wheels as well as the pair of front wheels. In this regard, reference is made to U.S. Pat. Nos. 5,540,297, 3,917,312, 4,861,056 and 4,455,031. In each case it will be noted that the wheelchair is restricted to a pair of rear drive wheels and a pair of front castor wheels.

In recent times, wheelchairs have been designed with a mid-wheel drive configuration which employs a pair of rear wheels, a pair of intermediate drive wheels, and a pair of anti-tipping front wheels which are normally held clear of the ground, for the purpose of improving the chair's turning ability and manoeuvrability. Common to mid-wheel drive chairs is a "teeter-totter" motion which occurs when the wheelchair rocks forward over the drive wheels. This motion will normally occur when the vehicle is going down inclines, stopping, or slowing. Any unsafe forward tilting or tipping movement of the chair is avoided by virtue of the front anti-tipper wheels which ensure that the chair does not topple. It is also known for the anti-tipper wheels to be located at the rear of the base frame of the wheelchair (rather than at the front thereof), with the pair of front castor wheels being mounted to, remain in permanent contact with the ground. An example of this is shown in U.S. Pat. No. 5,540,297.

It has now been found that considerable improvement in wheelchair ride and comfort, as well as wheelchair manoeuvrability, can be achieved by employing a wheelchair having a mid-wheel drive configuration in association with a pair of front castor wheels and a pair of rear castor wheels which remain in constant contact with the ground, and wherein the front and mid-drive wheel on each side of the chair frame are independently sprung with respect to the base frame of the wheelchair.

It is the main object of the present invention therefore to provide a mid-wheel drive wheelchair which has a novel underframe which includes three sets of ground engaging wheels and which incorporates a very simple and inexpensive suspension arrangement for improving rider comfort, stability and manoeuvrability of the wheelchair.

It is another object of the present invention to provide a mid-wheel drive wheelchair which has improved driving wheel traction properties.

Broadly according to this invention therefore, a mid-wheel drive wheelchair comprises:

a central base frame,

a seat or chair frame attachable to the base frame, a pair of leading pivot arms pivotally supported on opposite sides of said base frame for independent pivotal movement relative to the base frame about a common transverse pivot axis, each said pivot arm extending forwardly of the front end of the base frame, a mid-drive wheel mounted for rotation on each of said pivot arms adjacent its trailing end, with the axle of each drive wheel being located a short distance rearwardly of the pivot axis of the pivot arms, a pair of ground-engaging front castor wheels respectively mounted at the leading ends of said pivot arms, spring means respectively acting between each said side pivot arm and an adjacent side portion of the base frame, said spring means, in use, being arranged to resist pivotal movement of its associated said pivot arm and to allow the base frame to tilt under spring pressure with respect to the pivot arms, and

a pair of ground engaging rear castor wheels preferably located on opposite sides of the base frame and spaced rearwardly therefrom, said rear castor wheels being movably supported with respect to the base frame.

Desirably the rear castor wheels are respectively rotatably mounted at opposite ends of a rigid transverse support arm which extends across the width of the wheelchair and is pivotally connected to the rear end of the base frame, centrally thereof, for rotation about a central longitudinal axis.

Preferably each of the mid-drive wheels is coupled to an electric drive motor so that the wheelchair can be power driven.

Preferably each said spring means comprises a pair of coil compression springs respectively located fore and aft of the pivot axis of their associated pivot arm.

In a preferred embodiment of the invention, the chair or seat frame is releasably attached to said base frame by releasable spring-loaded locking means.

Preferably the distance between the pivot axis and the axis of each of the drive wheel axles is small relative to the length of the pivot arm, so as to provide a mechanical advantage for each of the pivot arms when the front castor wheel is vertically displaced, eg when travelling over uneven terrain. This in turn also minimises vertical displacement of the base frame and thereby improves rider comfort over uneven terrain.

Preferably the chair or seat of the wheelchair is attached to the base frame in a manner so that substantially the whole weight of the wheelchair rider is distributed over the mid-drive wheels, so as to provide better traction for the drive wheels, and avoid undesirable loading of the front castors. With conventional rear wheel drive wheelchairs, the weight distribution tends to be too far back and the chair can become unstable, eg by tipping backwards.

In order to more fully explain the present invention, an embodiment is described hereunder in some further detail with reference to the accompanying drawings wherein:

FIG. 1 is a front perspective view of the underframe of a mid-wheel drive wheelchair designed in accordance a preferred embodiment of the present invention;

FIG. 2 is a plan view of the underframe assembly shown in FIG. 1 (and which also shows part of the seat frame shown in FIG. 3);

FIG. 3 is a side elevational view of the underframe assembly shown in FIG. 2 and which shows the wheelchair seat and seat frame fitted thereto; while

FIG. 4 is a fragmentary partly sectioned, elevational view of the spring mount for each leading pivot arm.

Referring to the drawings, a mid-wheel drive wheelchair **10** includes an approximately central base frame or under-frame **11** of rectangular shape, a seat frame **12** removably attached to the base frame **11**, a pair of laterally spaced leading pivot arms **13, 14** each pivotally attached to a respective side frame member **15, 16** of the base frame **11** for pivotal movement about a common transverse pivot axis **17**, a pair of ground engaging mid-drive wheels **19, 20** each rotatably mounted adjacent the trailing end of a respective side pivot arm **13, 14**, a pair of ground engaging front castor wheels **21, 22** rotatably mounted at the leading ends of the pivot arms **13, 14**, and a pair of ground engaging rear castor wheels **23, 24** which are rotatably mounted at the opposite ends of a rigid transverse support arm **25** which itself is pivotally mounted to the rear of the base frame **11** centrally thereof, for pivotal movement about a central longitudinal axis **26**.

As shown in FIG. 2, each of the side pivot arms **13, 14** is spring-mounted in relation to the base frame **11** by means of pairs of coil springs **28, 29** respectively, there being one spring on each side of the pivot axis **17**, whereby any pivotal movement of the arms **13, 14** is cushioned by the coil springs and in turn provides a cushioning effect for the base frame when the wheelchair **10** travels over uneven terrain the arrangement of the leading pivot arms **13, 14** and the coil springs **28, 29** forms an independent suspension for each of the front castor wheels **21, 22** and permits the wheels **21, 22** to travel up and down independently of the other, and furthermore allows forward tilt movement of the base frame **11** about pivot axis **17** relative to the arms **13, 14** by virtue of there being no mechanical connection between the forward ends of the base frame **11** and the arms **13, 14**.

In this embodiment, each one of each pair of coil springs **28, 29** is loosely located in a tubular sleeve **30** welded to a base plate **31** which is fixed to an inner side of the arm **13, 14** and projects inwardly thereof (refer FIG. 4). The upper end of the coil spring abuts against an angle plate **32** welded to a respective side frame member **15, 16** of the base frame **11**. In this embodiment the fore and aft coil springs of each pair are approximately equally spaced from the pivot axis **17** (although this is not essential).

As also shown in FIG. 2, each of the mid-drive wheels **19, 20** is rotatably mounted on an axle **34, 35** respectively which itself is journaled for rotation in a bearing carried by the arm **13, 14**, with the common axis **36** of the axles **34, 35** being spaced a short distance rearwardly of the pivot axis **17** so as to provide a mechanical advantage for the arms **13, 14** when they undergo pivotal movement.

It is a feature of the present invention that the front castor wheels **21, 22**, the mid-drive wheels **19, 20** and the rear castor wheels **23, 24** remain substantially in constant contact with the ground regardless of its unevenness, with the sets of front and rear castor wheels **21, 22** and **23, 24** providing vastly increased stability and balance for the wheelchair and its occupant particularly when the wheelchair is travelling over a steep incline or decline. It will also be appreciated that in the event of either one of the front castor wheels undergoing vertical movement, eg by running over an obstruction, the upward pivotal movement of the pivot arm **13, 14** will result in increased traction for the drive wheel **19, 20**, with the base frame **11** undergoing very little displacement. The front and rear castor wheels also greatly increase the sterility and manoeuvrability of the wheelchair **10**, particularly in confined spaces.

As shown in FIG. 3, the seat frame **12** is releasably secured to the base frame **11** by means of an angle latch bar **40** which interlocks with the front cross-bar **41** of the base

frame **11** which extends across the width thereof. The rear bottom end of the seat frame **12** is held in place by means of a pair of spring-loaded latch members **42** which mockingly engage with the rear ends of bottom rails **43, 44** of the seat frame **12**, and which locate directly on top of the side frame members **15, 16** of the base frame **11**. The latches **42** are retracted by means of a pull-cord **45** to a release position to enable the seat frame **12** to be detached from the base frame **11**.

The seat frame **12** is supported above the base frame **11** by means of transversely spaced apart pairs of uprights **47** which extend between the bottom rails **43, 44** and the underside of the seat base **48**. As shown in FIG. 3, the seat frame **12** and its seat **48** are located almost directly above the axles **34, 35** of the mid-drive wheels **19, 20**. As a result, almost all of the weight of the wheelchair occupant is distributed over the drive wheels **19, 20** which affords better stability and traction.

Desirably, each of the drive wheels **19, 20** is driven by an electric motor **51** mounted by means of a motor mounting plate **50** fixed to and depending from the pivot arm **13, 14** adjacent its trailing end. In accordance with known art, each of the drive motors is coupled to a gearbox which can be engaged and disengaged by a control lever mounted on the seat frame **12**. With the gearbox disengaged, the drive wheels can be manually driven or the wheelchair pushed by an assistant from behind. Due to the improved weight distribution afforded by the positioning of the seat frame **12** directly above the drive wheels **19, 20**, the wheelchair can be easily pushed with very little manual effort required.

Also in accordance with known art, the base frame **11** is provided with a cradle **52** for locating and storing batteries for powering the electric motors.

A brief consideration of the above-described embodiment will indicate that the invention provides for a very simple and relatively inexpensive construction for an underframe of a mid-wheel drive wheelchair, one which provides vastly improved ride characteristics, stability, manoeuvrability, and steerability for a wheelchair, and which avoids the use of anti-tip stabilising wheels. By having three pairs of wheels remaining in constant contact with the ground, regardless of its unevenness, the stability and balance of the chair is significantly improved, particularly when travelling down or up sharp inclines, or in the event of the wheelchair coming to a sudden stop.

The claims defining the invention are as follows:

1. A mid-wheel drive wheelchair comprising:

- a central base frame,
- a seat or chair frame attachable to said base frame,
- a pair of leading pivot arms pivotally supported on opposite sides of said base frame for independent pivotal movement relative to the base frame about a common transverse pivot axis, each said pivot arm extending forwardly of the front end of the base frame,
- a mid-drive wheel mounted for rotation on each of said pivot arms adjacent its trailing end, with the axle of each drive wheel being located a short distance rearwardly of the common transverse pivot axis of said pivot arms,
- a pair of ground engaging front castor wheels respectively mounted at the leading ends of said pivot arms,
- spring means respectively acting between each said pivot arm and an adjacent side portion of the base frame, said spring means, in use, being arranged to resist pivotal movement of its associated said pivot arm and to allow the base frame to tilt under spring pressure with respect to the pivot arms, and

5

a pair of transversely spaced apart ground engaging rear castor wheels movable supported with respect to said base frame.

2. A mid-wheel drive wheelchair according to claim 1 wherein said rear castor wheels are respectively rotatable mounted at opposite ends of a rigid transverse support arm which extends across the width of the wheelchair and is pivotally connected to the rear end of the base frame, centrally thereof, for rotation about a central longitudinal axis.

3. A mid-wheel drive wheelchair according to either claim 1 or claim 2 wherein each said spring means comprises a pair of coil compression springs respectively located fore and aft of the pivot axis of the associated pivot arm.

4. A mid-wheel drive wheelchair according to claim 1 wherein the distance between said common transverse pivot axis and the axis of each drive wheel axle is small relative to the length of the pivot arm, so as to provide a mechanical advantage for each of the pivot arms when its front castor wheel is vertically displaced.

5. A mid-wheel drive wheelchair according to claim 1 wherein the seat or chair frame is attached to said base frame in a manner so that substantially the whole weight of the

6

wheelchair rider is distributed over the mid-drive wheels, so as to provide improved traction for said drive wheels.

6. A mid-wheel drive wheelchair according to claim 1 wherein the seat or chair frame has a pair of base rails extending longitudinally of said base frame, each said base rail being releasably attached, at its rear end to said base frame by releasable spring loaded locking means.

7. A mid-wheel drive wheelchair according to claim 6 wherein said central base frame includes a transverse cross bar at its forward end, and wherein said seat or chair frame includes a transverse hook defining rail extending between said base rails at or adjacent their forward ends and which is arranged to hookingly engage with said cross bar for securing the forward end of the seat or chair frame to the base frame.

8. A mid-wheel drive wheelchair according to claim 1 wherein each of the mid-drive wheels is coupled to an electric drive motor, each said motor being mounted by means of a motor mounting plate fixed to and depending from its associated said pivot arm adjacent its trailing end thereof.

\* \* \* \* \*





US006196343C1

(12) **EX PARTE REEXAMINATION CERTIFICATE** (6918th)  
**United States Patent**  
**Strautnieks**

(10) **Number:** **US 6,196,343 C1**  
(45) **Certificate Issued:** **Jul. 7, 2009**

(54) **MID-WHEEL DRIVE WHEELCHAIR**

3,664,450 A 5/1972 Udden et al.  
3,682,462 A 8/1972 Papousek

(75) Inventor: **Maris Strautnieks**, Woodcroft (AU)

(Continued)

(73) Assignee: **Invacare Corporation**, Elyria, OH (US)

**FOREIGN PATENT DOCUMENTS**

**Reexamination Request:**

No. 90/007,491, Mar. 31, 2005

CA 2254372 5/2000  
DE 10136368 C2 2/2003  
DE 10136368 A1 2/2003  
DE 10136369 C2 2/2003  
DE 10136369 A1 2/2003

**Reexamination Certificate for:**

Patent No.: **6,196,343**  
Issued: **Mar. 6, 2001**  
Appl. No.: **09/426,369**  
Filed: **Oct. 25, 1999**

(Continued)

**OTHER PUBLICATIONS**

(30) **Foreign Application Priority Data**

Oct. 23, 1998 (AU) ..... PP6704

(51) **Int. Cl.**

**A61G 5/00** (2006.01)  
**A61G 5/04** (2006.01)  
**A61G 5/06** (2006.01)  
**A61G 5/10** (2006.01)  
**B62D 61/10** (2006.01)

Request for Reexamination of U.S. Patent No. 6,196,343, Filed on Apr. 28, 2006 (113 pages).

“Big Boulder Power Wheelchair: Conventional “Tubular” Style Frame”; <http://www.wheelchairs.com/bigboulder-page.htm>, Accessed on the World Wide Web on Dec. 17, 2003, p. 1–4.

(Continued)

*Primary Examiner*—Peter C. English

(52) **U.S. Cl.** ..... **180/22; 180/907**

(58) **Field of Classification Search** ..... None  
See application file for complete search history.

(57)

**ABSTRACT**

(56) **References Cited**

**U.S. PATENT DOCUMENTS**

2,427,482 A 9/1947 Wiessman  
2,986,200 A 5/1961 Nobile  
3,104,112 A 9/1963 Crail  
3,174,176 A 3/1965 Olson  
3,191,990 A 6/1965 Rugg et al.  
3,195,670 A 7/1965 Dunn  
3,210,092 A 10/1965 Kraus  
3,573,877 A 4/1971 Locke  
3,580,591 A 5/1971 Coffey et al.  
3,589,700 A 6/1971 Ruet et al.  
3,592,282 A 7/1971 Zamotin  
3,602,522 A 8/1971 Soileau  
3,661,228 A 5/1972 Glasser

The invention provides a mid-wheel drive wheelchair assembly (10) which includes a central base frame (11), a seat frame (12) removably attached to the base frame (11), a pair of transversely spaced leading pivot arms (13, 14) pivotally attached to opposite sides of the base frame respectively for pivotal movement about a common transverse pivot axis (17), a pair of ground engaging mid-drive wheels (19, 20) each mounted adjacent the trailing end of a respective side pivot arm (13, 14), a pair of ground engaging front castor wheels (21, 22) rotatably mounted at the leading ends of the pivot arms (13, 14), and a pair of ground engage rear castor wheels (23, 24) rotatably mounted at opposite ends of a rigid transverse port arm (25) which itself is pivotally mounted to the rear of the base frame (11) centrally thereof. Each of the pivot arms (13, 14) is spring mounted with respect to the base frame by means of coil springs (28, 29) arranged so that any pivotal movement of the arms is cushioned by the coil springs.

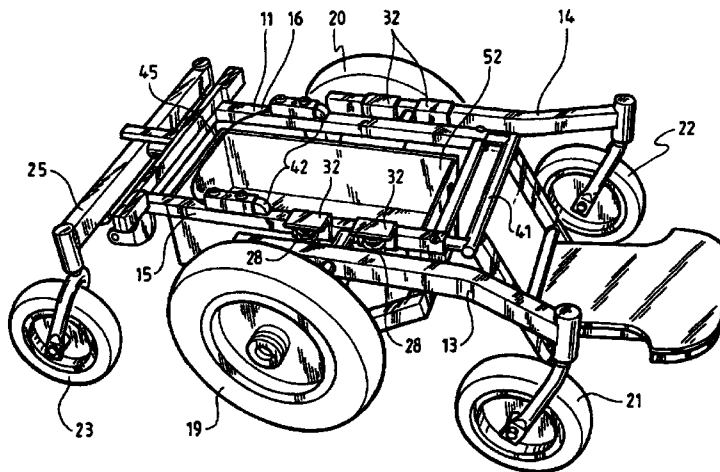

U.S. PATENT DOCUMENTS

3,709,313 A	1/1973	James		5,513,875 A	5/1996	Tahara et al.	
3,848,883 A	11/1974	Breacain		5,518,081 A	5/1996	Thibodeau	
3,862,751 A	1/1975	Schwaller		5,531,284 A	7/1996	Okamoto	
3,876,012 A	4/1975	Regier		5,540,297 A	* 7/1996	Meier .....	180/65.5
3,883,153 A	5/1975	Singh et al.		5,562,172 A	10/1996	Mick	
3,901,527 A	8/1975	Danziger et al.		5,564,512 A	10/1996	Scheulderman	
3,905,437 A	9/1975	Kaiho et al.		5,575,348 A	11/1996	Goertzen et al.	
3,917,312 A	* 11/1975	Rodaway .....	280/250.1	5,611,555 A	3/1997	Vidal	
3,952,822 A	4/1976	Udden et al.		5,727,802 A	3/1998	Garven, Jr. et al.	
3,953,054 A	4/1976	Udden et al.		5,772,237 A	6/1998	Finch et al.	
3,976,152 A	8/1976	Bell		D397,645 S	9/1998	Schaffner	
4,108,449 A	8/1978	Rhodes		5,833,248 A	11/1998	Eguchi	
4,118,020 A	10/1978	Myers		5,848,658 A	* 12/1998	Pulver .....	180/65.1
4,119,163 A	10/1978	Ball		5,851,019 A	12/1998	Gill et al.	
4,128,137 A	12/1978	Booth		5,853,059 A	12/1998	Goertzen et al.	
4,222,449 A	9/1980	Feliz		D404,693 S	1/1999	Schaffner	
4,264,085 A	4/1981	Volin		5,855,387 A	1/1999	Gill et al.	
4,310,167 A	1/1982	McLaurin		5,899,475 A	5/1999	Verhaeg et al.	
4,333,681 A	6/1982	Nelson		5,904,214 A	5/1999	Lin	
4,337,958 A	7/1982	Witt et al.		5,944,131 A	8/1999	Schaffner et al.	
4,341,278 A	7/1982	Meyer		5,954,351 A	9/1999	Koschinat	
4,375,295 A	3/1983	Volin		5,964,473 A	10/1999	Degonda et al.	
4,437,678 A	3/1984	Schultz		6,003,624 A	12/1999	Jorgensen et al.	
4,455,029 A	6/1984	Taylor		6,041,876 A	3/2000	Pulver et al.	
4,455,031 A	6/1984	Hosaka		6,047,979 A	4/2000	Kraft et al.	
4,483,407 A	11/1984	Iwamoto et al.		6,062,600 A	5/2000	Kamen et al.	
4,500,102 A	2/1985	Haury et al.		6,070,898 A	6/2000	Dickie et al.	
4,513,832 A	4/1985	Engman		6,079,698 A	6/2000	Patterson et al.	
4,545,593 A	10/1985	Farnam		6,079,725 A	6/2000	Lazaros	
4,545,616 A	10/1985	Booth		D429,665 S	8/2000	Dickie	
4,556,229 A	12/1985	Bihler et al.		6,129,165 A	10/2000	Schaffner et al.	
4,565,385 A	1/1986	Morford		6,131,679 A	10/2000	Pulver et al.	
RE32,242 E	9/1986	Minnebraker		6,176,335 B1	1/2001	Schaffner et al.	
4,618,155 A	10/1986	Jayne		6,179,076 B1	1/2001	Fernie et al.	
4,687,068 A	8/1987	Pagett		6,186,252 B1	2/2001	Schaffner et al.	
4,720,223 A	1/1988	Neights et al.		6,196,343 B1	3/2001	Strautnieks	
4,721,322 A	1/1988	Hawkins		6,199,647 B1	3/2001	Schaffner et al.	
4,759,418 A	7/1988	Goldenfeld et al.		6,206,119 B1	3/2001	Wu	
4,805,712 A	2/1989	Singleton		6,209,670 B1	4/2001	Fernie et al.	
4,811,966 A	3/1989	Singleton		6,225,894 B1	5/2001	Kyrtos	
4,823,900 A	4/1989	Farnam		6,234,263 B1	5/2001	Boivin et al.	
4,826,194 A	5/1989	Sakita		6,234,507 B1	5/2001	Dickie et al.	
4,840,394 A	6/1989	Bickler		6,279,927 B1	8/2001	Nishihira et al.	
4,861,056 A	* 8/1989	Duffy et al. ....	280/250.1	6,312,000 B1	11/2001	Pauls et al.	
4,862,983 A	9/1989	Kreft		6,322,089 B1	11/2001	Dantele et al.	
4,886,294 A	12/1989	Nahachewski		6,341,657 B1	1/2002	Hopely et al.	
4,905,972 A	3/1990	Scowen		6,341,671 B1	1/2002	Ebersole	
4,919,441 A	4/1990	Marier et al.		6,347,688 B1	2/2002	Hall et al.	
4,926,952 A	5/1990	Farnam		6,357,793 B1	3/2002	Dickie et al.	
4,934,626 A	6/1990	Kimura		6,405,816 B1	6/2002	Kamen et al.	
4,962,942 A	10/1990	Barnett et al.		6,428,020 B1	8/2002	Steadman	
5,123,495 A	6/1992	Littlejohn et al.		6,454,286 B1	9/2002	Hosino	
5,176,393 A	1/1993	Robertson et al.		6,460,641 B1	10/2002	Kral	
5,180,275 A	1/1993	Czech et al.		6,460,869 B1	10/2002	Tremouilles	
5,183,133 A	2/1993	Roy et al.		6,533,305 B1	3/2003	Falk	
5,222,567 A	6/1993	Broadhead et al.		6,533,306 B2	3/2003	Watkins	
5,228,709 A	7/1993	Kao		6,543,564 B1	4/2003	Kamen et al.	
5,230,522 A	7/1993	Gehlsen et al.		6,543,798 B2	4/2003	Schaffner et al.	
5,241,876 A	9/1993	Mathis		6,554,086 B1	4/2003	Goertzen et al.	
5,248,007 A	9/1993	Watkins et al.		6,568,030 B1	5/2003	Watanabe et al.	
5,290,055 A	3/1994	Treat, Jr.		6,581,711 B1	6/2003	Tuluie	
5,294,141 A	3/1994	Mentessi et al.		6,588,799 B1	7/2003	Sanchez	
5,316,328 A	5/1994	Bussinger		6,640,916 B2	11/2003	Schaffner et al.	
5,341,533 A	8/1994	Seitz		6,688,437 B2	2/2004	Usherovich	
5,351,744 A	10/1994	Larsson		6,715,845 B2	4/2004	Kamen et al.	
5,372,211 A	12/1994	Wilcox et al.		6,923,280 B2	8/2005	Goertzen et al.	
5,435,404 A	* 7/1995	Garin, III .....	180/6.5	6,935,448 B2	8/2005	Goertzen et al.	
5,447,317 A	9/1995	Gehlsen et al.		2003/0030243 A1	2/2003	Engles et al.	
5,467,838 A	11/1995	Wu		2003/0075365 A1	4/2003	Fought	
5,482,261 A	1/1996	Ortega		2003/0122332 A1	7/2003	Engles et al.	
				2004/0032119 A1	2/2004	Tran et al.	

## FOREIGN PATENT DOCUMENTS

EP	127929	12/1984
EP	677285	10/1995
EP	908165	4/1999
EP	908166	4/1999
EP	988848	3/2000
EP	1279391	1/2003
EP	1279392	1/2003
FR	2399822	3/1979
FR	2498925	8/1982
JP	58-48304	3/1983
JP	04-158864	6/1992
JP	07-328073	12/1995
JP	08-038552	2/1996
JP	410248877	9/1998
JP	2000 102569	4/2000
JP	2000 288032	10/2000
JP	2001 070347	3/2001
JP	2001 104391	4/2001
JP	2001 212181	8/2001
JP	2001 258948	9/2001
JP	2001 327545	11/2001
JP	2002 143223	5/2002
JP	2002 165841	6/2002
WO	WO 82/00445	2/1982
WO	WO 84/04451	11/1984
WO	WO 90/06097	6/1990
WO	WO 92/09463	6/1992
WO	WO 93/24342	12/1993
WO	WO 96/15752	5/1996
WO	WO 98/46184	10/1998
WO	WO 00/08910	2/2000
WO	WO 00/09356	2/2000
WO	WO 00/12040	3/2000
WO	WO 00/66060	11/2000
WO	WO 02/34190	5/2002
WO	WO 2003/030800	4/2003

## OTHER PUBLICATIONS

“Boulder Plus Power Wheelchair: Conventional “Tubular” Style Frame”; <http://www.wheelchairs.com/plus.htm>, Accessed on the World Wide Web on Dec. 17, 2003, p. 1–4.  
 “Frog Legs: Smooth Ride Ahead”; <http://www.froglegsinc.com/index.php>, accessed on the World Wide Web on Dec. 17, 2003, p. 105.

“Frog Legs Tires”, <http://mdtap.org/tt/1999.09/prod.html>, Accessed on the World Wide Web on Dec. 17, 2003, p. 1–3.

“Invacare Pronto M71 Jr. Power Wheelchair Manual”; Accessed on the World Wide Web on Dec. 17, 2003.

“Invacare Storm Series TDX Power Wheelchairs Manual”; Accessed on the World Wide Web on Dec. 17, 2003, p. 1–24.

“Invacare Xterra Series GT Power Wheelchair Manual”; Accessed on the World Wide Web on Dec. 17, 2003, p. 1–4.

“Jazzy 1122”, Pride Mobile Products Corp., Accessed on the World Wide Web on Dec. 17, 2003, p. 1–2.

“Jazzy 1133”, Pride Mobile Products Corp., Accessed on the World Wide Web on Dec. 17, 2003, p. 1–2.

“Jazzy 1170XL”, Pride Mobile Products Corp., Accessed on the World Wide Web on Dec. 17, 2003, p. 1–2.

“Bruno Independent Living Aids ISP 9001 Certified”; [http://www.bruno.com/power\\_chairs.htm](http://www.bruno.com/power_chairs.htm), Accessed on the World Wide Web on Dec. 17, 2003, p. 1–5.

“Top End Terminator SS Sports Wheelchair”, [http://phc-online.com/terminator\\_ss.htm](http://phc-online.com/terminator_ss.htm), Accessed on the World Wide Web on Dec. 17, 2003, p. 1–5.

“Transactions of the Institute of Measurement and Control”, The British Library of Science Technology and Business, vol. 24, Nov. 5, 2002, p. 1–15.

MJ Lawn et al. “Modeling of a Stair-Climbing Wheelchair Mechanism with High Single-Step Capability” IEEE Transactions on Neural Systems and Rehabilitation Engineering, Sep. 2003.

Quickie G-424 User Instruction Manual & Warranty, 930484 Rev. A (27 sheets).

10 Photographs (8.5×11) of Quickie G-424 Wheelchair obtained Nov. 24, 2004.

Sunrise Medical, Inc., Power Products Parts Manual, 930307 Rev. K (531 sheets), Jul. 2004. (Note: various dates are listed therein.).

“All-Terrain Wheelchair, Designer’s Corner”, Design News, Feb. 24, 1992, cover page and p. 54.

International Search Report from PCT/US98/07543 which cited FR 2399822.

\* cited by examiner

**1**  
**EX PARTE**  
**REEXAMINATION CERTIFICATE**  
**ISSUED UNDER 35 U.S.C. 307**

THE PATENT IS HEREBY AMENDED AS  
INDICATED BELOW.

**2**  
AS A RESULT OF REEXAMINATION, IT HAS BEEN  
DETERMINED THAT:  
  
The patentability of claims **3** and **7** is confirmed.  
5 Claims **1, 2, 4-6** and **8** are cancelled.

\* \* \* \* \*